

LINKED SYSTEM SELECTION

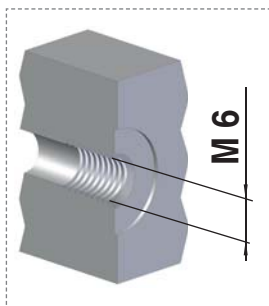

MINIMESS - CONNECTIONS
S12,65x1,5

TM

Low gas flow

MICRO - CONNECTIONS
M8x1

Twin seal

TSM

Low gas flow

JIC 37° - CONNECTIONS
7/16"-20 UNF

TNC

High gas flow

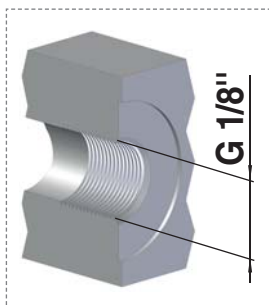

ORFS - CONNECTIONS
9/16"-18 UNF

HY 400

High gas flow

EO - 24° - CONNECTIONS
M12x1,5

Twin seal

HY 500

High gas flow

IT

- Pressa trasportabile con pompa pneumatica idraulica
- Idonea per raccordi dritti, 45° e 90°

EN

- Transportable press with hydraulic manual pump
- Suitable for straight, 45° and 90° fittings

DE

- Transportable Presse mit manueller Hydraulikpumpe
- Geeignet für gerade, 45° und 90° Anschlüsse

FR

- Presse transportable avec pompe oléodynamique manuelle
- Utilisable avec raccords droits, 45° et 90°

ES

- Prensa transportable con bomba oleodinámica manual
- Puede ser utilizada con tuberías derechas, 45° y 90°

PT

- Prensa transportável com bomba hidráulica manual
- Pode ser usado com tubos retos, 45° e 90°

code 39PR06A



code 58UT022A (included)



IT Utensile rimuovi morsetti con calamita
EN Magnet tool to remove pressing jaws
DE Magnetwerkzeug für die Entfernung von Pressbacken
FR Outil magnétique pour enlever les mâchoires de pressage
ES Herramienta magnética para la remoción de las mordazas de prensado
PT Ferramenta magnética para remover os mordentes de prensar

code 58UT001A (optional)



IT Forbice taglia tubo
EN Scissor for hose
DE Schlauchschneideschere
FR Ciseaux coupe-tube
ES Tijeras cortatubos
PT Tesouras corta tubos

code 58UT023A (optional)



IT Lampada led con magnete
EN LED Light with magnet
DE LED-Lampe mit Magnet
FR Lampe à LED magnétique
ES Lámpara LED con imán
PT Lâmpada LED com íman

AIR	7 bar 110 psi	100 TON 110 US TON	380 x 430 x 400 mm 15 x 17 x 16 inch	38 kg 84 lb
				-5 ÷ 40 °C 23 ÷ 104 °F

CONNECTIONS	ORFS "TSM" HOSE Ø 5,5 p. 248	Micro 32° - JIC 37° "TSM" HOSE Ø 5,5 p. 238 - 242	Minimess "TM" HOSE Ø 5,1 p. 240	JIC 37° "TNC" HOSE Ø 8,1 p. 238	EO 24° "HY 500" HOSE Ø 11 p. 234	ORFS "HY 400" HOSE Ø 12,7 p. 246
PRESSING JAWS	code 39MTR10 (optional) 	code 39MTR11 (optional) 	code 39MTR12 (optional) 	code 39MTR13 (optional) 		

Ordering example: **39PR06A + 39MTR11** | Pressing jaws for Jic 37° "TNC" HOSE Ø 8,1

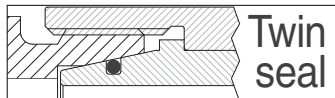

code 36HY50001...

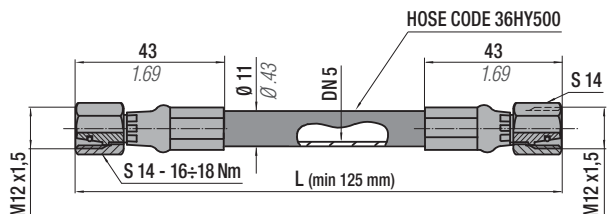

code 36HY50002...

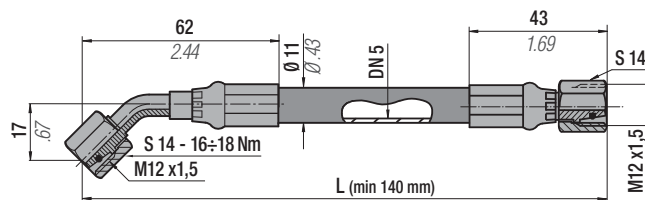

code 36HY50003...

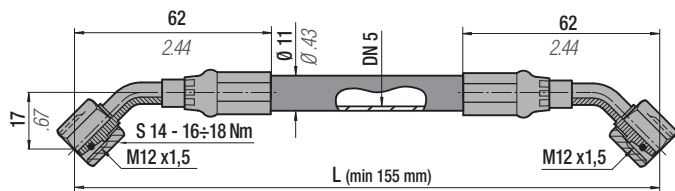

code 36HY50004...

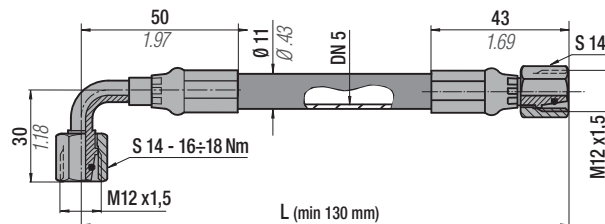

code 36HY50005...

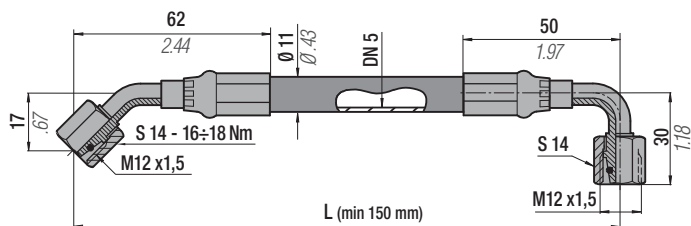

code 36HY50006...

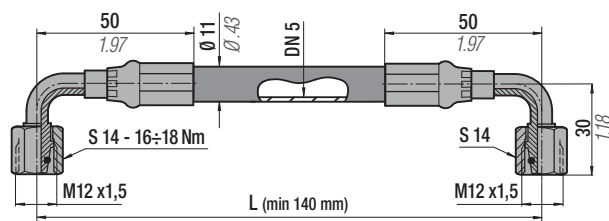

Technical data

"L" min	See above	-	Volume	18 ml/metre
Operation pressure	345 bar	5003 psi	Dimension	3/16" (external Ø 11 mm)
Burst Pressure	1380 bar at 20°C	20010 psi at 68°F	Material	Thermoplastic
R (bending radius)	40 mm	1.57 in	Standard	SAE 100R8
Operation temperature	-40+ 100°C	-38+212°F	Outer casing	Perforated



Lunghezza richiesta comprensiva di raccordi terminali
Length upon request including end hose fittings
Länge Anfrage einschließlich Ende Schlaucharmaturen

Longueur requise, y compris des raccords d'extrémité
Longitud requerida, incluyendo accesorios de los extremos
Comprimento necessário incluindo todos os acessórios

code: 36FF11A

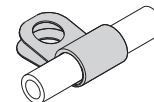
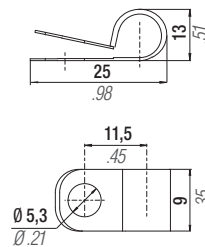

standard L = 120 mm min. - 5 mm upword increase - Example (36HY50001 0300; 36HY50001 0305; ...)

HOSE FITTINGS

code 36P2401

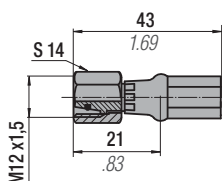

code 36P2402

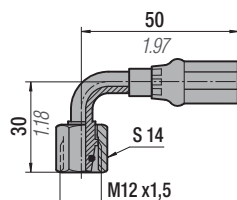

code 36P2403

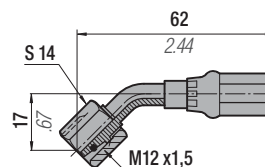

Raccordi tubo-cilindro/pannello - Hose-cylinder/panel connections - Anschlüsse zwischen schlauch und Zylinder/Kontrollarmatur - Raccords tuyau-cylindre/tableau - Conexiones sistema de cilindros/panel - Racord tubo-cilindro/painel

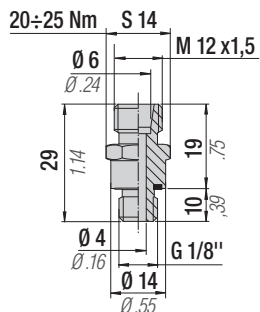
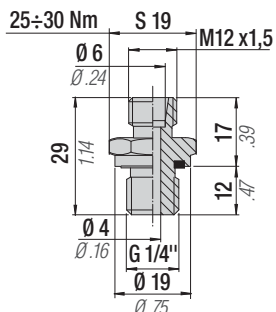
code 36R2401

code 36R2402

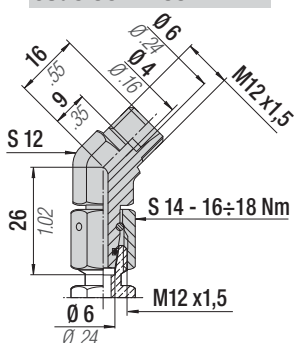
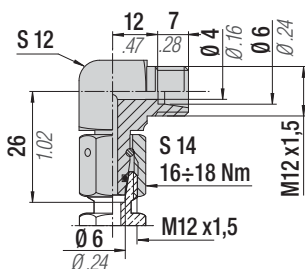
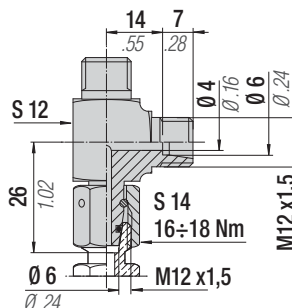
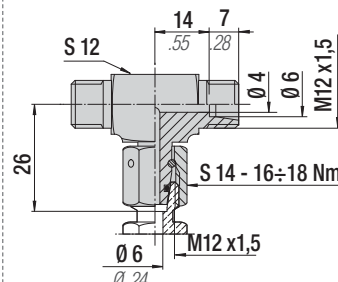
Raccordi di derivazione - Offtake connections - Anschlußstutzen - Raccords de dérivation - Racores - Racord de derivação

code 36R2403

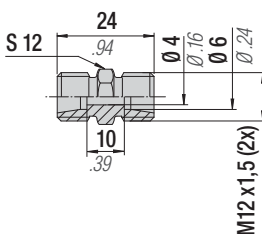
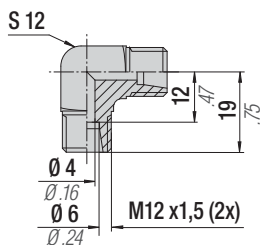
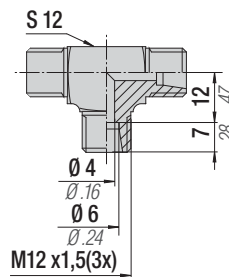
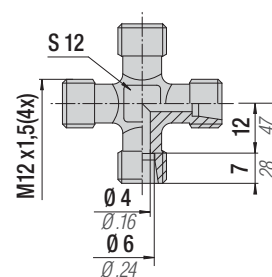
code 36R2404

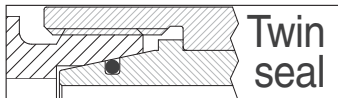
code 36R2405

code 36R2406

Raccordi tubo-tubo - Hose-hose connections - Anschlüsse zwischen Schlauch und Schlauch - Raccords tuyau-tuyau - Conexiones de tubo a tubo - Racord tubo-tubo

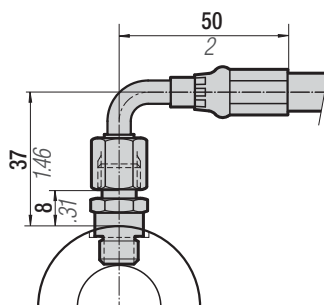
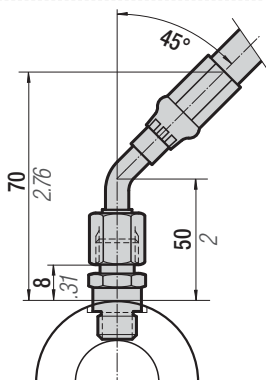
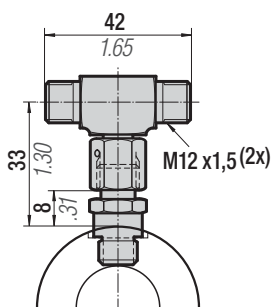
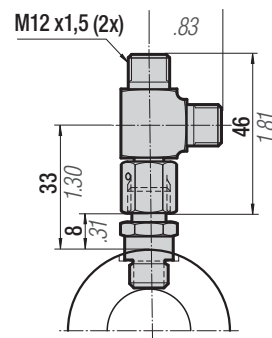
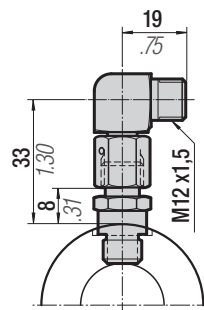
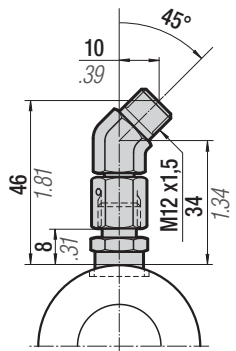
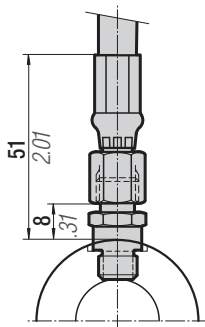
code 36R2407

code 36R2408

code 36R2409

code 36R2410



Esempi di installazione - Installation examples - Einbaubeispiele - Exemples de montage - Ejemplos de instalación - Exemplos de instalação





THIS PAGE IS INTENTIONALLY LEFT BLANK



code TNC 7/16...

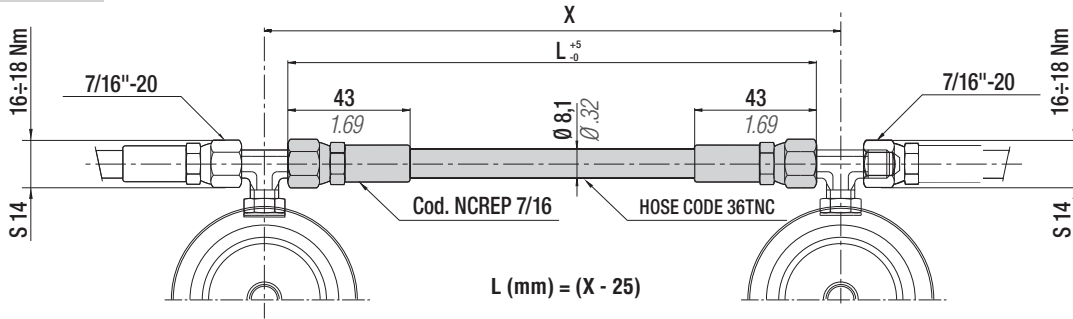

Technical data				
"L" min	140 mm	5.51 in	Volume	12,6 ml/metre
Operation pressure	420 bar	6090 psi	Dimension	1/8" (external ø 8,1 mm)
Burst Pressure	1680 bar at 20°C	24360 psi at 68°F	Material	Thermoplastic
R (bending radius)	25 mm	0.98 in	Standard	SAE 100R8
Operation temperature	-40+ 100°C	-38 +212°F	Outer casing	Perforated



Lunghezza standard (mm) inclusive di n. 2 raccordi NCREP 7/16
Standard lengths (mm) inclusive of no. 2 connections NCREP 7/16
Standard-Länge (mm) einsch. 2 NCREP 7/16 - Anschlüssen

Longueur standard (mm) comprenant 2 raccords NCREP 7/16
Longitud estándar (mm) con 2 racores incluidos NCREP 7/16
Comprimento standard (mm) incluído nas 2 ligações NCREP 7/16

standard L = 140 mm min. - 5 mm upword increase - Example (TNC 7/16 140 mm; TNC 7/16 145 mm ...)

code: 36FF09A

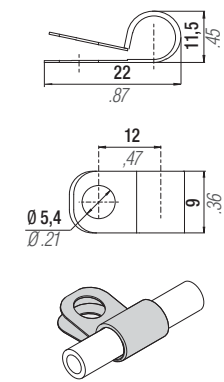

TSM **JIC 37°
Hose Ø 5,5 mm**

code TSM7/16...

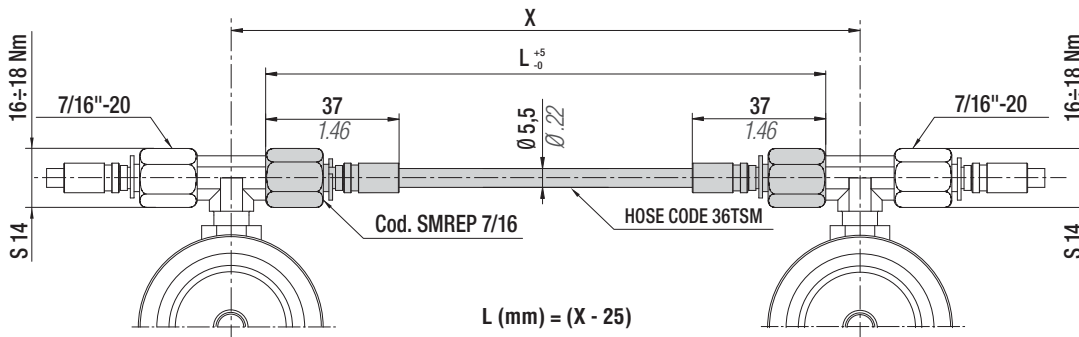

Technical data				
"L" min	90 mm	3.54 in	Volume	3 ml/metre
Operation pressure	630 bar	9135 psi	Dimension	5/64" (external ø 5,5 mm)
Burst Pressure	1890 bar at 20°C	27400 psi at 68°F	Material	Thermoplastic
R (bending radius)	20 mm	0.79 in	Standard	-
Operation temperature	-40+ 100°C	-38 +212°F	Outer casing	Perforated



Lunghezza standard (mm) inclusive di n. 2 raccordi SMREP 7/16
Standard lengths (mm) inclusive of no. 2 connections SMREP 7/16
Standard-Länge (mm) einsch. 2 SMREP 7/16 - Anschlüssen

Longueur standard (mm) comprenant 2 raccords SMREP 7/16
Longitud estándar (mm) con 2 racores incluidos SMREP 7/16
Comprimento standard (mm) incluído nas 2 ligações SMREP 7/16

standard L = 90 mm min. - 10 mm upword increase - Example (TSM 7/16 90 mm; TSM 7/16 100 mm ...)

code: 36FF06A

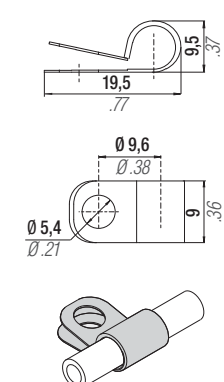

All dimensions in mm/inch

Raccordi tubo-cilindro/pannello - Hose-cylinder/panel connections - Anschlüsse zwischen schlauch und Zylinder/Kontrollarmatur -
Raccords tuyau-cylindre/tableau - Conexiones sistema de cilindros/panel - Racord tubo-cilindro/panel

code RTC-D

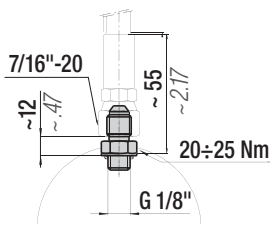

code RTC-M

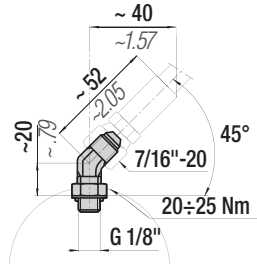

code RTC-R

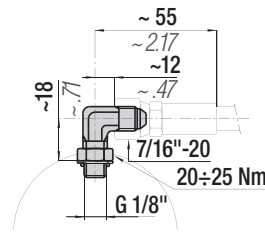

code RTC-L

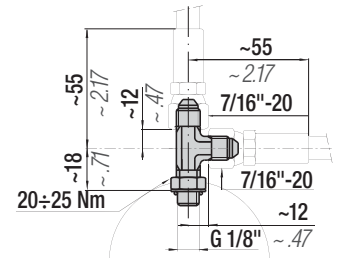

code RTC-T

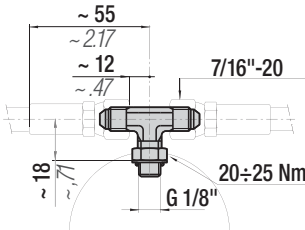

code 36J01A

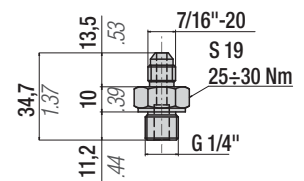

Raccordi di derivazione - Offtake connections - Anschlußstutzen - Raccords de dérivation - Racores - Racord de derivação

code RDR

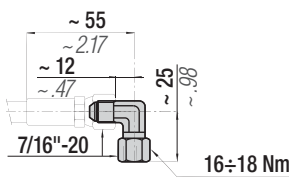

code RDT

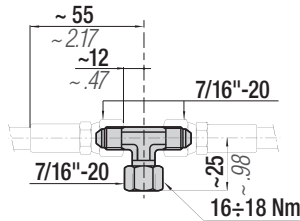

code RDM

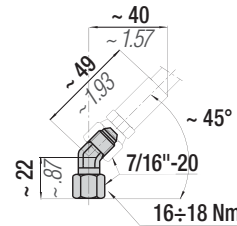

code RDL

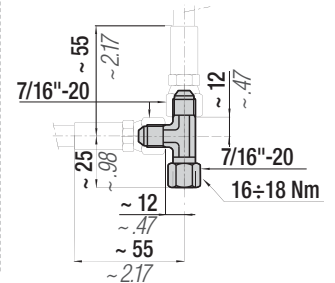

Raccordi tubo-tubo - Hose-hose connections - Anschlüsse zwischen Schlauch und Schlauch - Raccords tuyau-tuyau - Conexiones de tubo a tubo - Racord tubo-tubo

code RTT-D

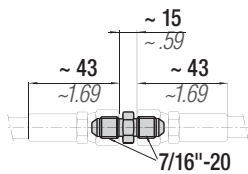

code RTT-R

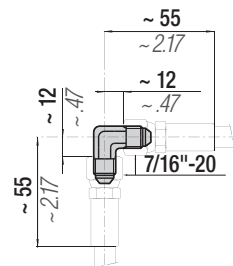

code RTT-T

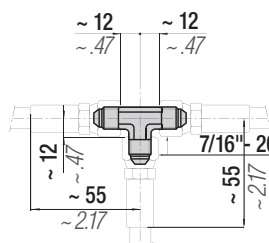

code RTT-C

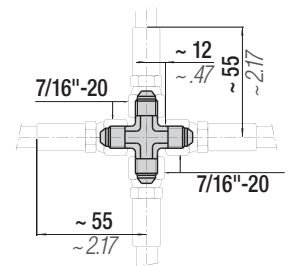

⚠ Available ONLY for loose supply

**JIC 37°
Hose Ø 8 mm**

TNB

PARKER made

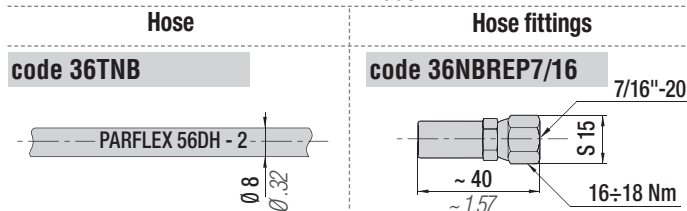

Technical data		
"L" min	140 mm	5.51 in
Operation pressure	415 bar	6017 psi
Burst Pressure	1655 bar at 20°C	24000 psi at 68°F
R (bending radius)	13 mm	0.51 in
Operation temperature	-40+ 100°C	-38+212°F

All dimensions in mm/inch

code TMD

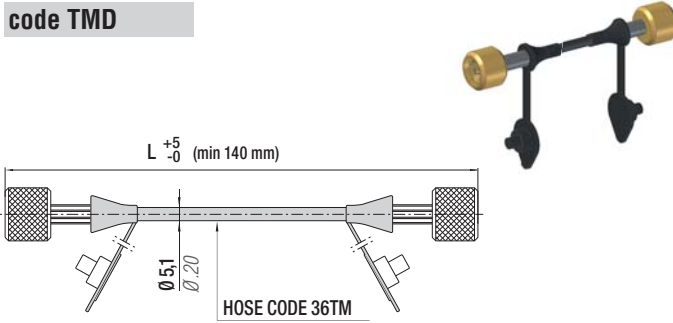

code TMDR

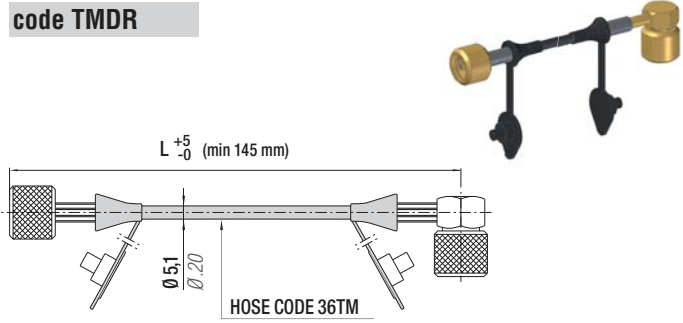

code TMR

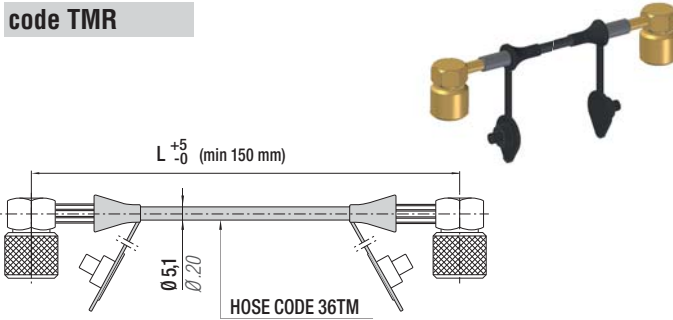

code TMR...V1

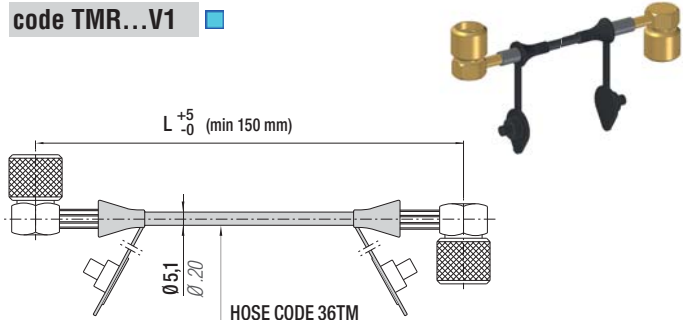

code TMR...V2

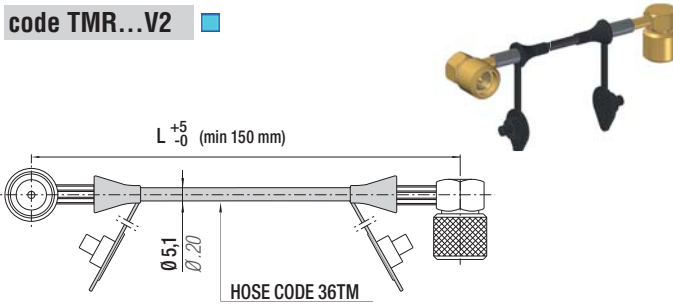

code TMR...V3

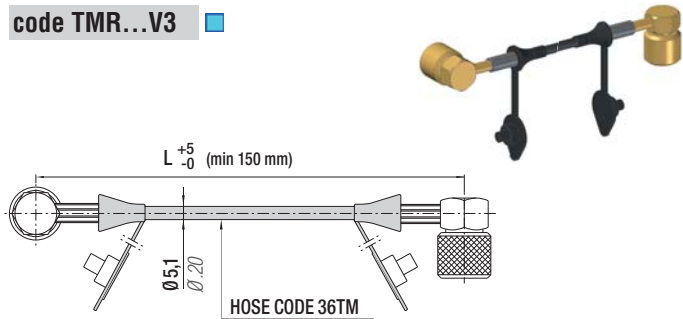

Technical data

"L" min (TMD - TMDR)	See above	-	Operation temp.	-20 +100°C	-2 +212°F
"L" min (TMR - TMR...)	See above	-	Dimension hose	5/64" (external Ø 5,1 mm)	
Operation pressure	630 bar	9135 psi	Material hose	Polyamid	
Burst Pressure	1950 bar at 20°C	28275 psi at 68°F	Standard	-	
R (bending radius)	20 mm	0.79 in	Outer casing hose	Perforated	



Lunghezze standard (mm) inclusive di n.2 raccordi e tappi
Standard lengths (mm) inclusive of n.2 connections and plugs
Standard-Länge (mm) einsch.2 und Stopfen Anschlüssen

Longueur standard (mm) comprenant 2 raccords et bouchons
Longitud estándar (mm) con 2 racores incluidos y tapones
Comprimento standard (mm) incluído nas 2 ligações e tampões

standard L = 140 mm min. - 10 mm upword increase - Example (TMD140; TMDR145; TMR150; TMR160V1; TMR170V2; ...)

HOSE FITTINGS

code 36MREPD

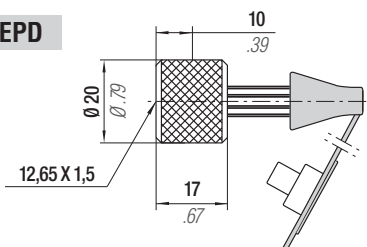

code 36MREPR

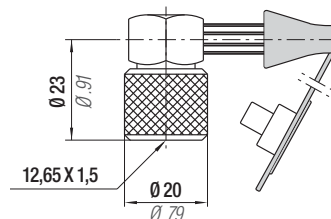

code: 36FF06A

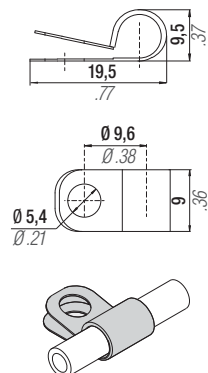

All dimensions in mm/inch

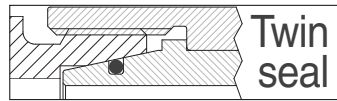

code TSM8...

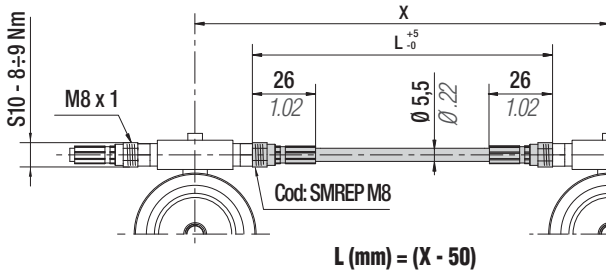

standard **L = 90 mm min. - 10 mm upword increase**
Example (TSM8 090 mm; TSM8 100 mm ...)

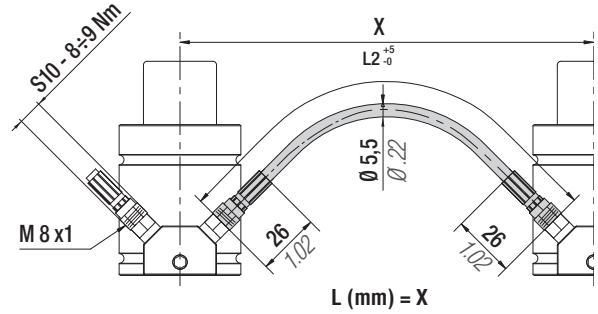

standard **L = 190 mm min. - 10 mm upword increase**
Example (TSM8 190 mm; TSM8 200 mm ...)

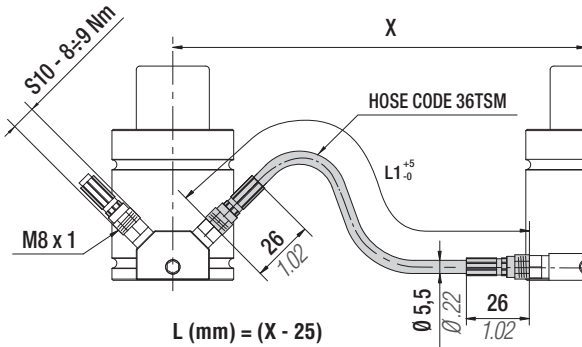

standard **L = 170 mm min. - 10 mm upword increase**
Example (TSM8 170 mm; TSM8 180 mm ...)

code: 36FF06A

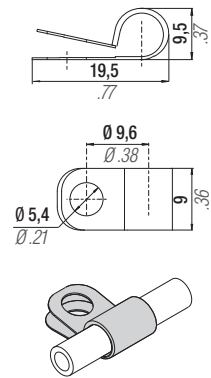

Technical data					
"L" min	90 mm	3.54 in	Operation temp.	-40 +100°C	-38 +212°F
"L1" min	170 mm	6.69 in	Volume	3 ml/metre	
"L2" min	190 mm	7.48 in	Dimension	5/64" (external Ø 5,5 mm)	
Operation pressure	630 bar	9135 psi	Material	Thermoplastic	
Burst Pressure	1890 bar at 20°C	27400 psi at 68°F	Standard	-	
R (bending radius)	20 mm	0.79 in	Outer casing	Perforated	



Lunghezze standard (mm) inclusive di n.2 raccordi SMREP M8
Standard lengths (mm) inclusive of no. 2 connections SMREP M8
Standard-Länge (mm) einsch. 2 SMREP-Anschlüssen M8

Longueur standard (mm) comprenant 2 raccords SMREP M8
Longitud estándar (mm) con 2 racores incluidos SMREP M8
Comprimento standard (mm) incluído nas 2 ligações SMREP M8

**TSM MICRO 32° and JIC 37°
Hose Ø 5,5 mm**

code TSM01A...

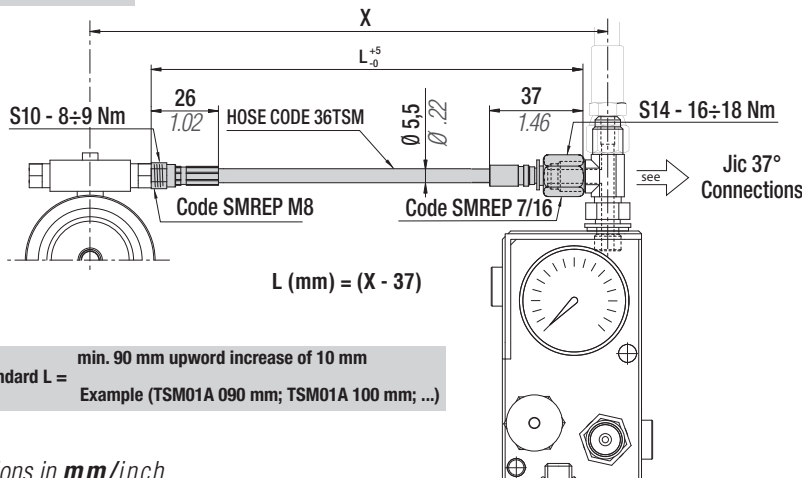

min. 90 mm upword increase of 10 mm
standard L =
Example (TSM01A 090 mm; TSM01A 100 mm; ...)

code: 36FF06A

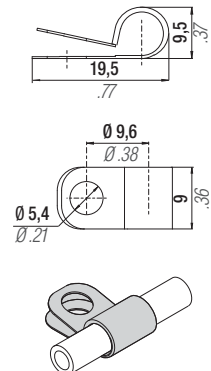

All dimensions in mm/inch

code 36TM01A...

code: 36FF06A

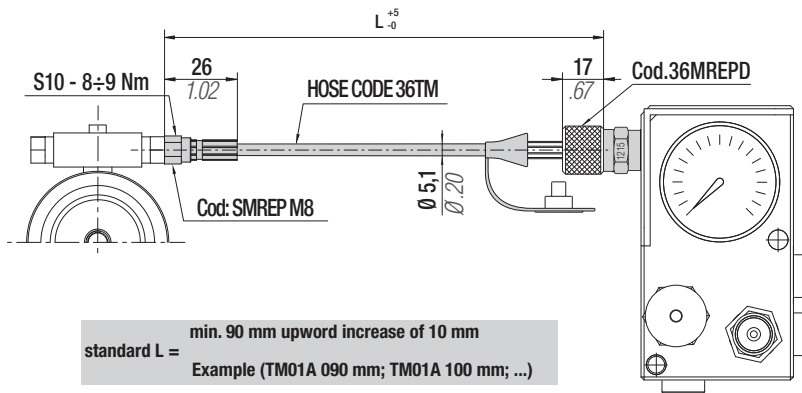
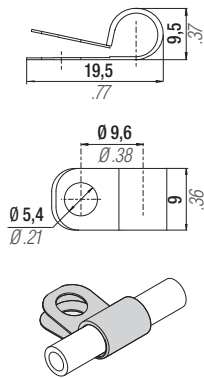

standard L = min. 90 mm upward increase of 10 mm
Example (TM01A 090 mm; TM01A 100 mm; ...)

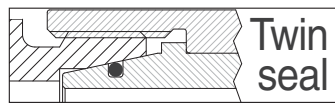

MICRO 32° CONNECTIONS

Blocchetto tubo-cilindro - Hose-cylinder block - Block, bestehend aus Schlauch-Zylinder - Bloc tube- cylindre - Bloque tubo-cilindro - Bloqueio do tubo-cilindro

code BDSM01

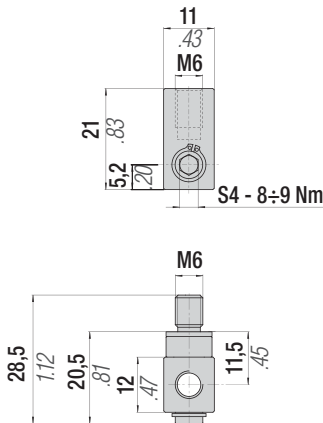

code BDSM02

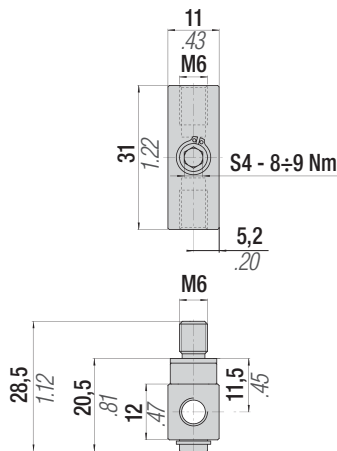

code BDSM02-45

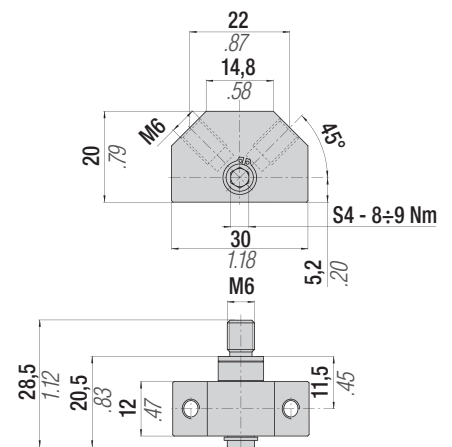

Raccordi tubo-tubo - Hose-hose connections - Anschlüsse zwischen Schlauch und Schlauch - Raccords tuyau-tuyau - Conexiones de tubo a tubo - Racord tubo-tubo

code 36MTTD

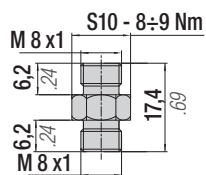

code 36RTTJM

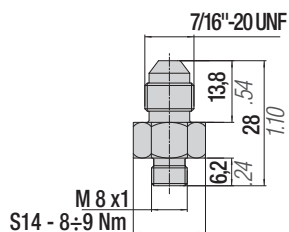

code 36M05A

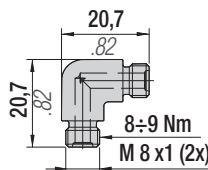

code 36M06A

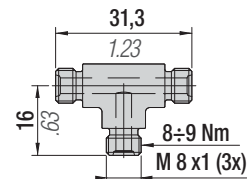

code 36M07A

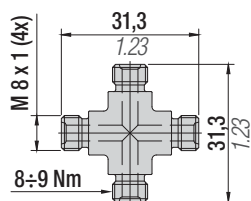

code 36HY40016...

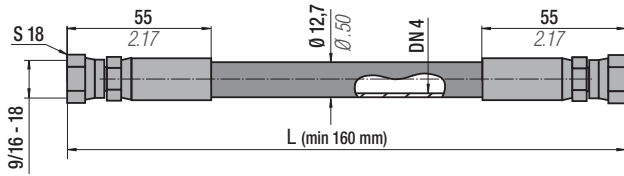

code 36HY40017...

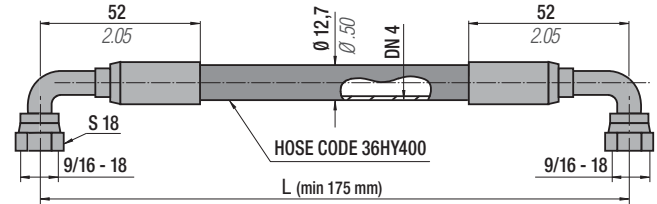

code 36HY40018...

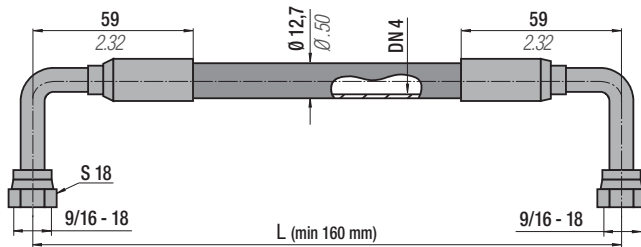

code 36HY40019...

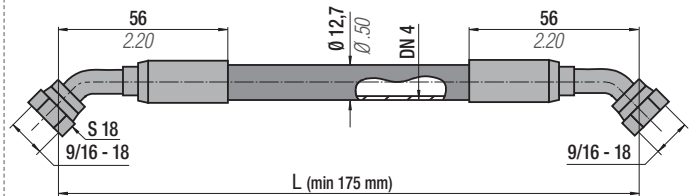

code 36HY40020...

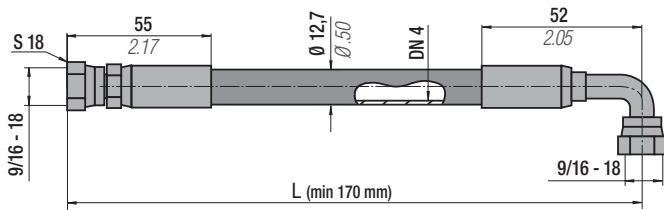

code 36HY40021...

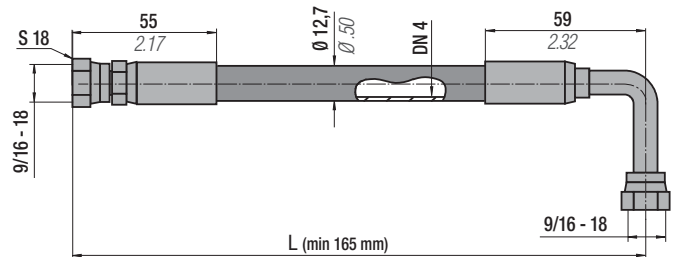

code 36HY40022...

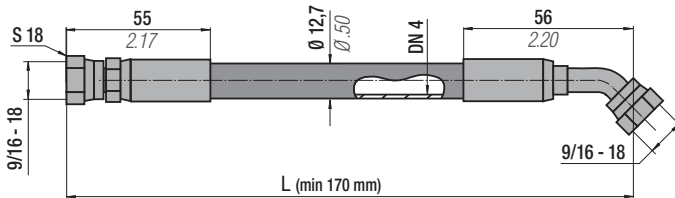

code 36HY40023...

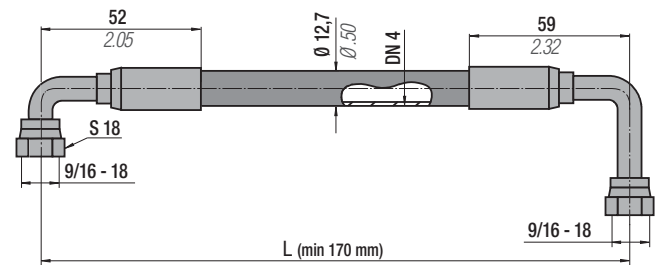

code 36HY40024...

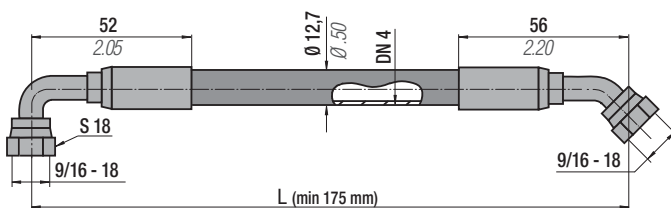

code 36HY40025...

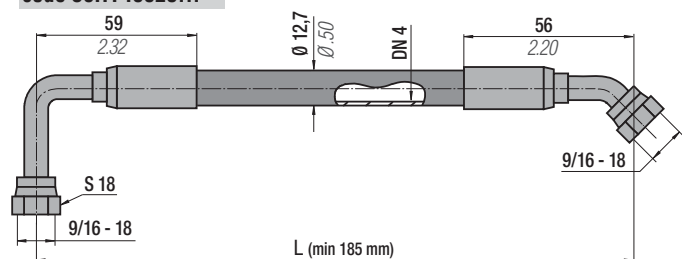

code 36HY40026...

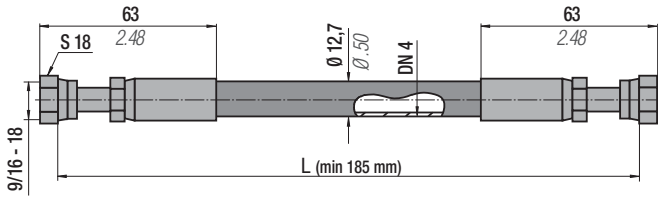

code 36HY40027...

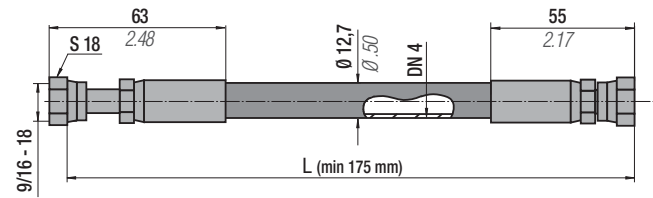

code 36HY40028...

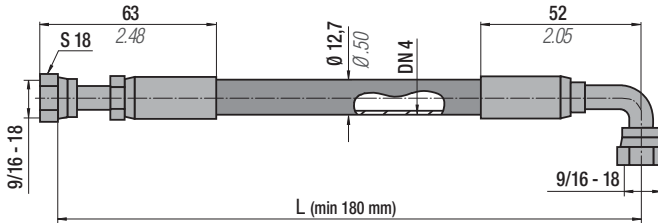

code 36HY40029...

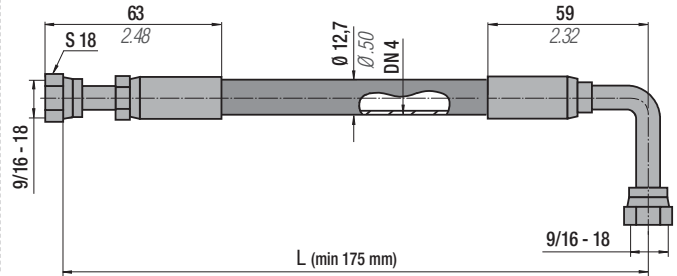

code 36HY40030...

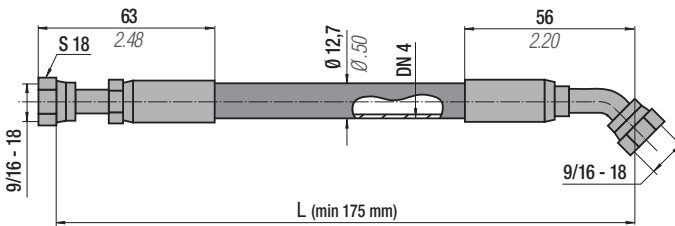

code: 36FF13A

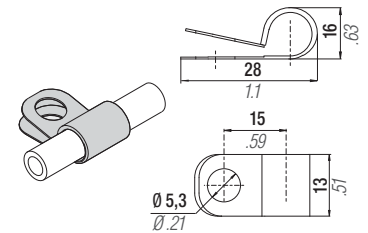

Technical data

"L" min	See above	-	Volume	32 ml/metre
Operation pressure	345 bar	5003 psi	Dimension	1/4" (external \varnothing 12,7 mm)
Burst Pressure	1380 bar at 20°C	20010 psi at 68°F	Material	Thermoplastic
R (bending radius)	51 mm	2.01 in	Standard	SAE 100R8
Operation temperature	-40+ 100°C	-38 +212°F	Outer casing	Perforated



Lunghezza richiesta comprensiva di raccordi terminali
 Length upon request including end hose fittings
 Länge Anfrage einschließlich Ende Schlaucharmaturen
 Longueur requise, y compris des raccords d'extrémité
 Longitud requerida, incluyendo accesorios de los extremos
 Comprimento necessário incluindo todos os acessórios

standard L = 255 mm min. - 5 mm upward increase - Example (36HY40016 0300; 36HY40016 0305; ...)

HOSE FITTINGS

code 36P9/1604

■ Straight Swivel

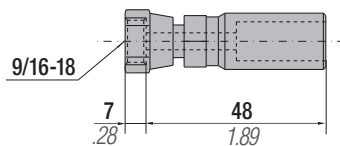

code 36P9/1605

■ Straight Long Swivel

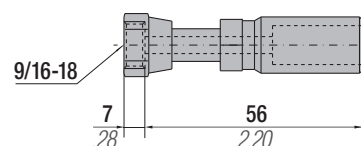

code 36P9/1606

■ 90° Long Swivel

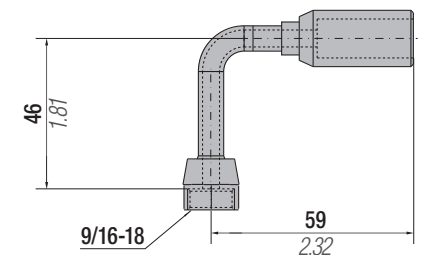

code 36P9/1607

■ 90° Swivel

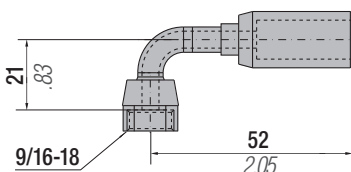

code 36P9/1608

■ 45° Swivel

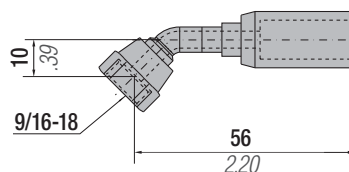

All dimensions in mm/inch

code 36TSM9/1601...

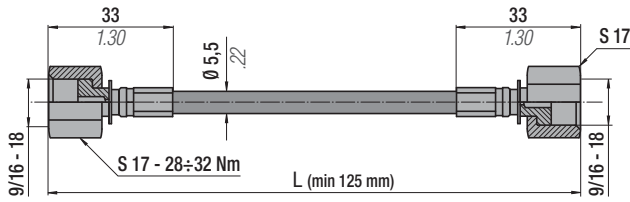

code 36TSM9/1602...

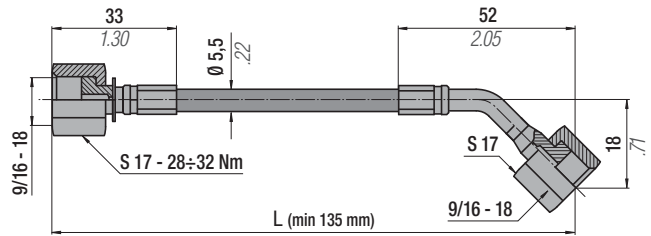

code 36TSM9/1603...

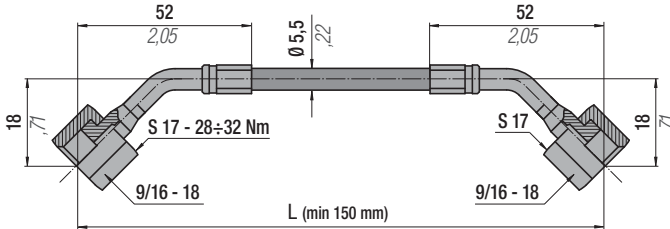

code 36TSM9/1604...

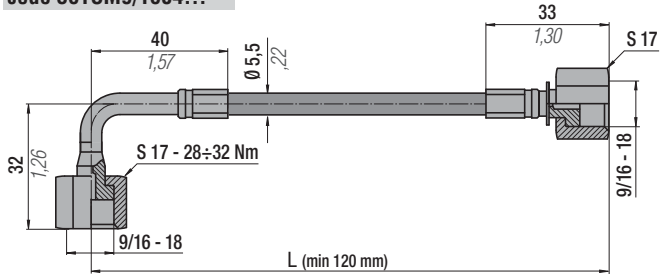

code 36TSM9/1605...

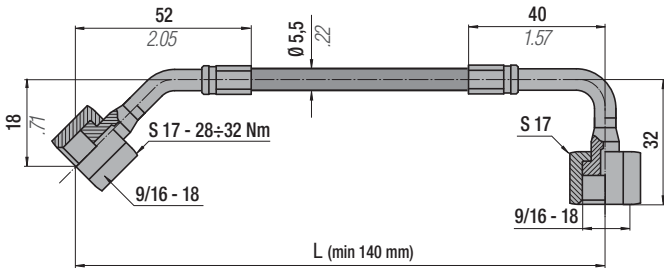

code 36TSM9/1606...

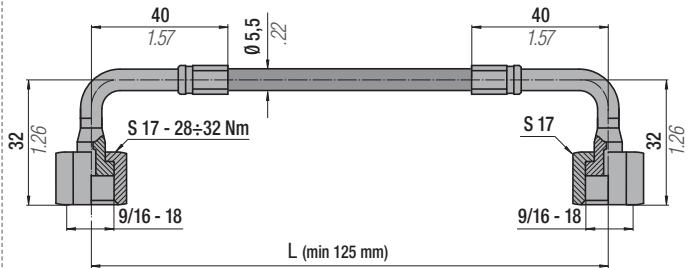

Technical data

"L" min	See above	-	Volume	3 ml/metre
Operation pressure	630 bar	9135 psi	Dimension	5/64" (external Ø 5,5 mm)
Burst Pressure	1890 bar at 20°C	27400 psi at 68°F	Material	Thermoplastic
R (bending radius)	20 mm	0,79 in	Standard	-
Operation temperature	-40+ 100°C	-38 +212°F	Outer casing	Perforated



Lunghezza richiesta comprensiva di raccordi terminali
Length upon request including end hose fittings
Länge Anfrage einschließlich Ende Schlaucharmaturen

Longueur requise, y compris des raccords d'extrémité
Longitud requerida, incluyendo accesorios de los extremos
Comprimento necessário incluindo todos os acessórios

standard L = 90 mm min. - 10 mm upward increase - Example (36TSM9/1601 0300; 36TSM9/1605 0310; ...)

code: 36FF06A

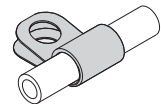
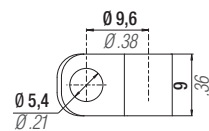
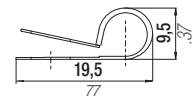

HOSE FITTINGS

code 36P9/1601

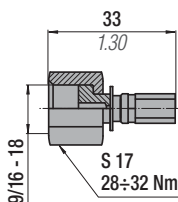

code 36P9/1602

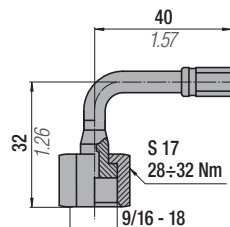

code 36P9/1603

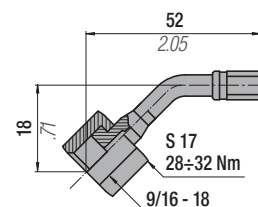

All dimensions in mm/inch

Raccordi tubo-cilindro/pannello - Hose-cylinder/panel connections - Anschlüsse zwischen schlauch und Zylinder/Kontrollarmatur - Raccords tuyau-cylindre/tableau - Conexiones sistema de cilindros/panel - Racord tubo-cilindro/panel

code PA-S Port Adapter - Straight

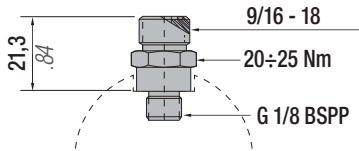

code PA-AS Port Adapter - Angle Swivel

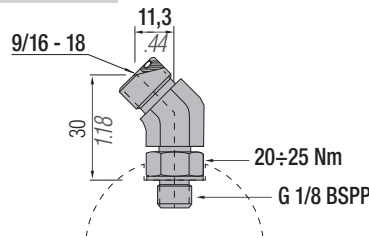

code PA-E Port Adapter - Elbow

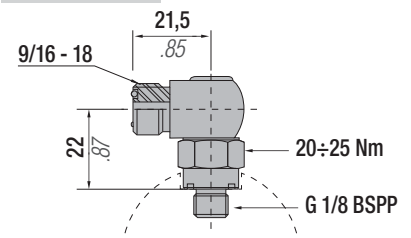

code PA-BTS Port Adapter - Branch Tee Swivel

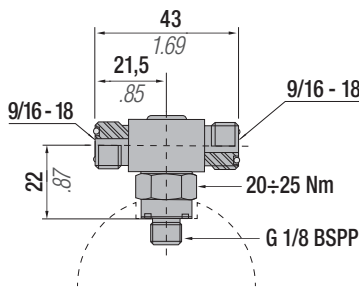

code PA-RT Port Adapter - Run Tee

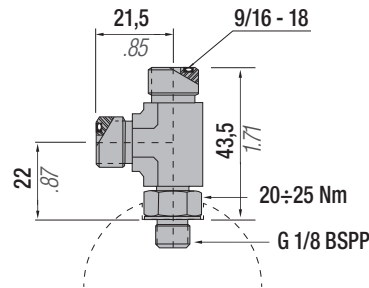

code PA-TWS Port Adapter - Two Way Swivel

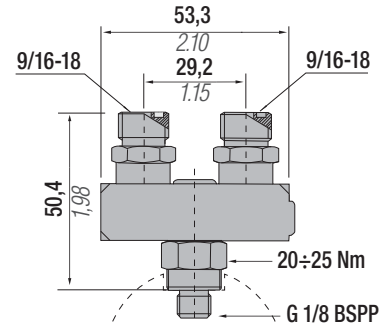

code PA-MWS Port Adapter - Multi Way Swivel

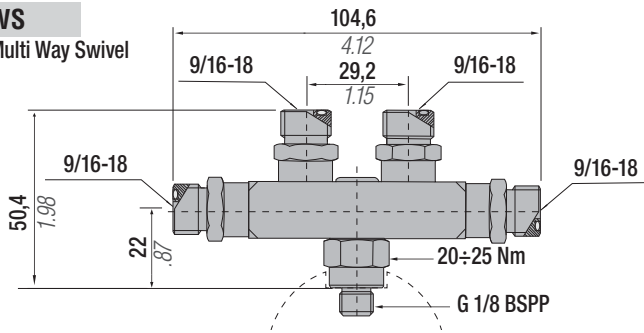

code PA-M6

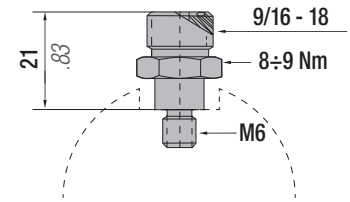

Raccordi di derivazione - Offtake connections - Anschlußstutzen - Raccords de dérivation - Racores - Racord de derivação

code SN-A Swivel Nut-Angle

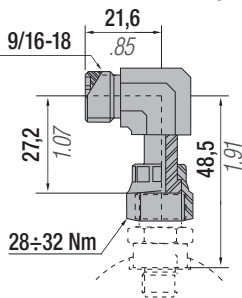

code SN-BT Swivel Nut-Branch Tee

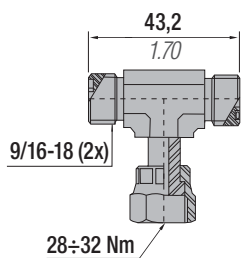

code SN-RT Swivel Nut-Run Tee

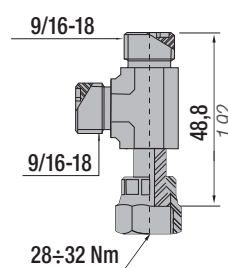

Raccordi tubo-tubo - Hose-hose connections - Anschlüsse zwischen Schlauch und Schlauch - Raccords tuyau-tuyau - Conexiones de tubo a tubo - Racord tubo-tubo

code F-U Fitting-Union

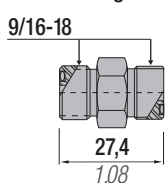

code F-E Fitting-Elbow

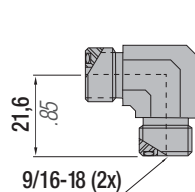

code F-T Fitting-Tee

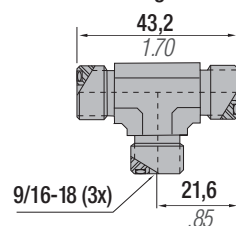

code F-C Fitting-Cross

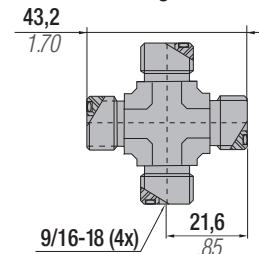

All dimensions in **mm/inch**



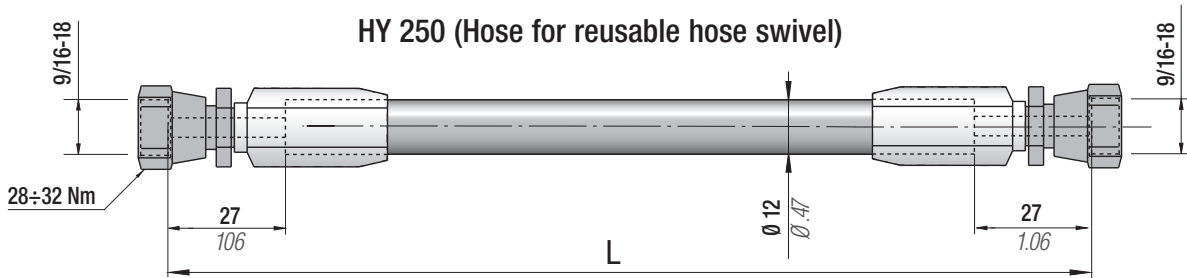

Technical data				
"L" min	254 mm	10,0 in	Volume	31 ml/metre
Operation pressure	190 bar	2750 psi	Dimension	1/4" (external Ø 12 mm)
Burst Pressure	758 bar at 20°C	11000 psi at 68°F	Material	Thermoplastic
R (bending radius)	38 mm	1,5 in	Standard	SAE 100R7
Operation temperature	-40+ 100°C	-38 +212°F	Outer casing	Perforated

standard L = 254 mm min. - Example(3) (36HY40005 12"(305); Length upon request including end hose fittings

REUSABLE HOSE SWIVELS

code SHF-R

Straight Swivel

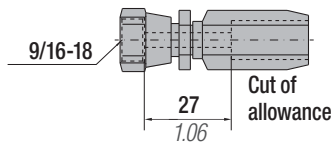

code HF-R90

90° Swivel

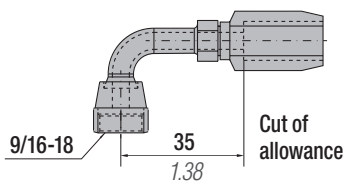

code HF-R45

45° Swivel

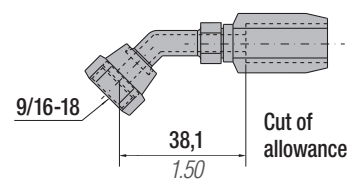



THIS PAGE IS INTENTIONALLY LEFT BLANK



code 36HY40001...

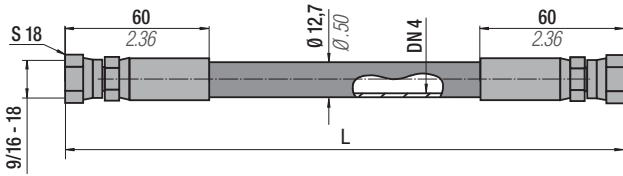

code 36HY40002...

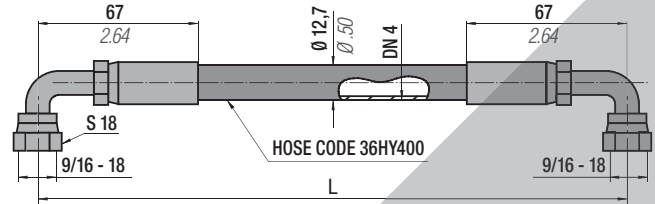

code 36HY40003...

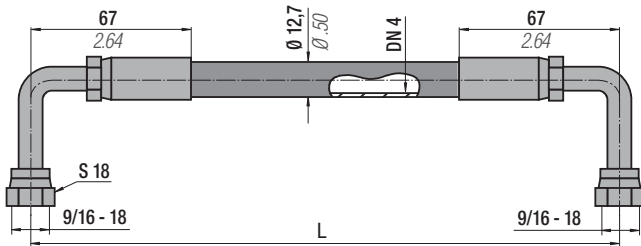

code 36HY40004...

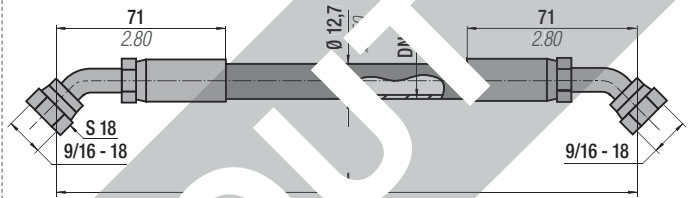

code 36HY40005...

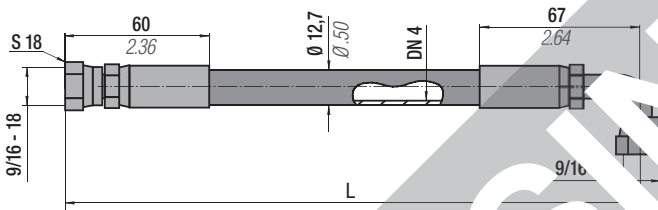

code 36HY40006...

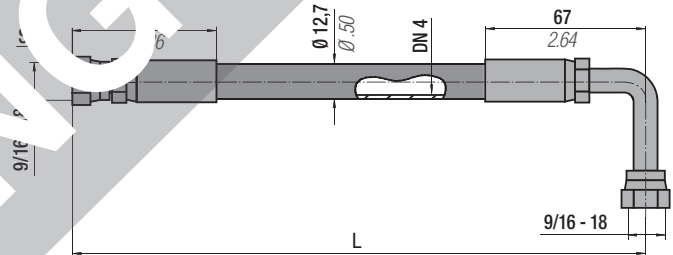

code 36HY40007...

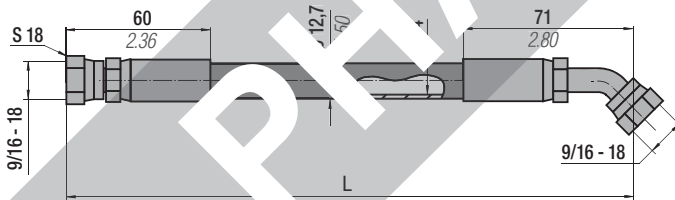

code 36HY40008...

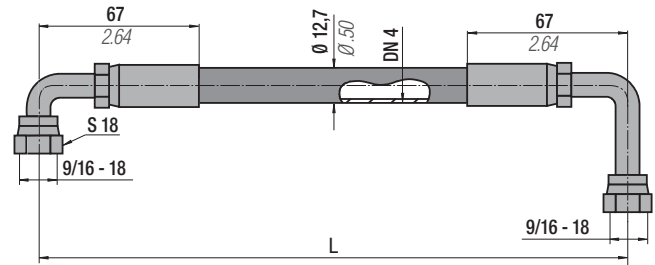

code 36HY40009...

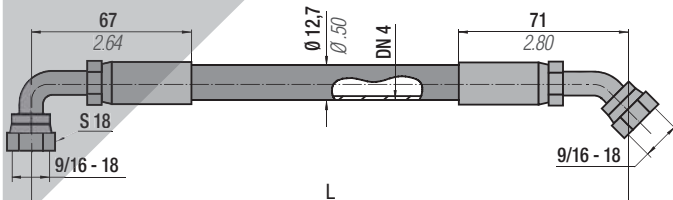

code 36HY40010...

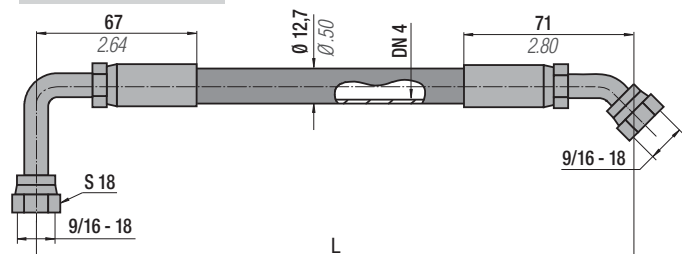

All dimensions in **mm/inch**

code 36HY40011...

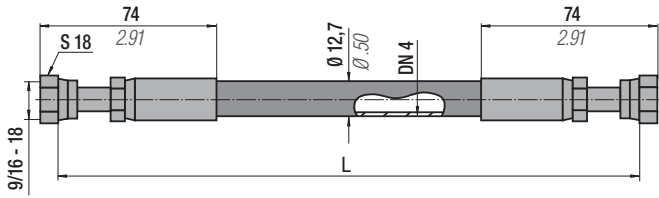

code 36HY40012...

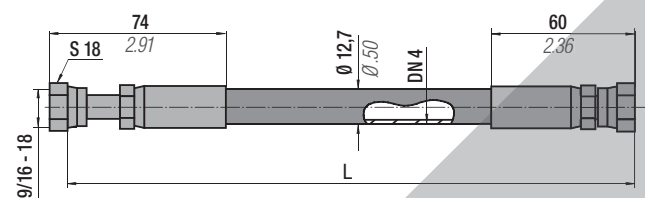

code 36HY40013...

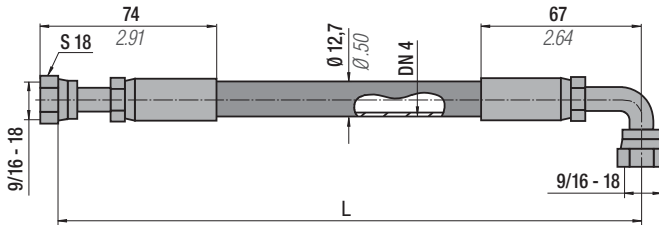

code 36HY40014...

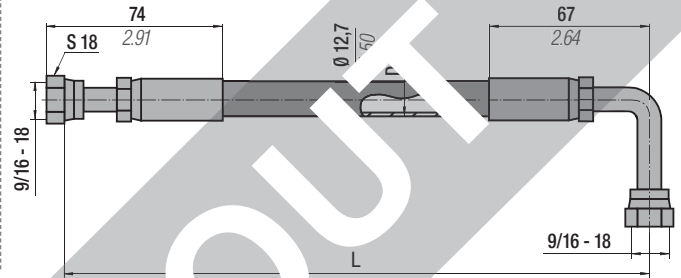

code 36HY40015...

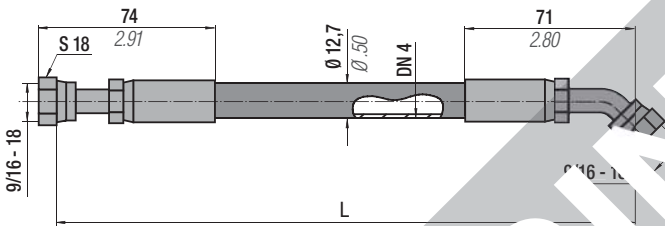

code: 36FF13A

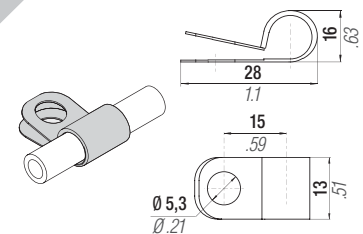

Technical data

"L" min	255 mm	Volume	32 ml/metre
Operation pressure	345 bar	Dimension	1/4" (external Ø 12,7 mm)
Burst Pressure	1380 bar at 20°C	Material	Thermoplastic
R (bending radius)	51 mm	Standard	SAE 100R8
Operation temperature	-40+120°C	Outer casing	Perforated



Lunghezza richiesta comprensiva di raccordi terminali
 Length upon request including end hose fittings
 Länge Anfrage einschließlich Ende Schlaucharmaturen
 Longueur requise, y compris des raccords d'extrémité
 Longitud requerida, incluyendo accesorios de los extremos
 Comprimento necessário incluindo todos os acessórios

standard L = 255 mm / 10.04 inch / 5 mm / 0.197 inch per word increase - Example (36HY40016 0300; 36HY40016 0305; ...)

HOSE FITTINGS

code S-F

Straight Swivel

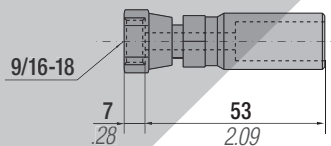

code S-FL

Straight Long Swivel

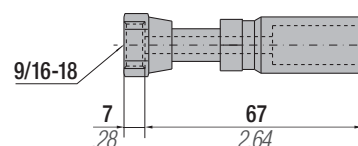

code H-F90L

90° Long Swivel

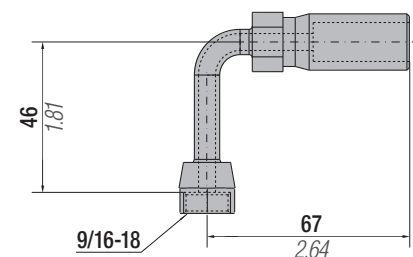

code H-F

90° Swivel

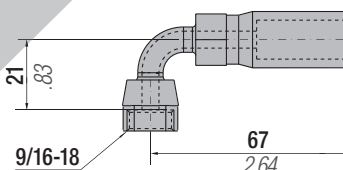

code H-F45

45° Swivel

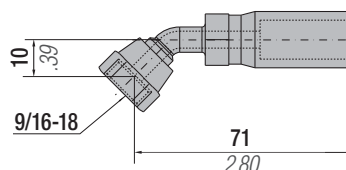

All dimensions in mm/inch

IT

Pannello standard per caricamento, regolazione, scaricamento e controllo della pressione nel sistema collegato. Consiste in una base provvista di manometro, valvola di caricamento e scaricamento, 3 uscite, protezione in acciaio. Può essere equipaggiato con disco di rottura (opzionale).

EN

Standard control panel to charge, adjust and check the pressure in the connected system. It consists of a plate with pressure gauge, charging and discharging valve, 3 outlets, steel case and can be equipped with a rupture disc (optional).

DE

Standard-Schalttafel zur Ladung, Regulierung, Entladung und Kontrolle des Drucks im angeschlossenen System. Bestehend aus einer Basis mit Manometer, Lade- und Entladeventil, 3 Ausgängen sowie Schutz aus Stahl. Kann mit einer Berstscheibe ergänzt werden (Zubehör).

FR

Panneau standard pour le chargement, le réglage, le déchargement et le contrôle de la pression dans le système relié. Il est formé par une embase équipée de manomètre, vanne de chargement et déchargement, 3 sorties, protection en acier. Il peut être équipé d'un disque de rupture (option).

ES

Panel standard para la carga, regulación, descarga y control de la presión en sistemas de cilindros conectados. Consiste en una base con un manómetro Válvula de carga y descarga, 3 salidas, protección en acero. Puede equiparse con disco de ruptura (opcional).

PT

Painel standard para carga, regulação, descarga e controlo da pressão no sistema ligado. É composto por uma base com manómetro. Válvula de carga e de descarga, 3 saídas, protecção em aço. Pode ser equipado com disco de rotura (opcional).

code	Pressure Gauge	Rupture Plug
39CPVC	bar/psi	✗
39CPVC + 39DR004	bar/psi	✓
39CPVC + 39TS460	bar/psi	✓

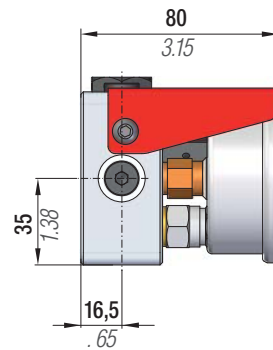
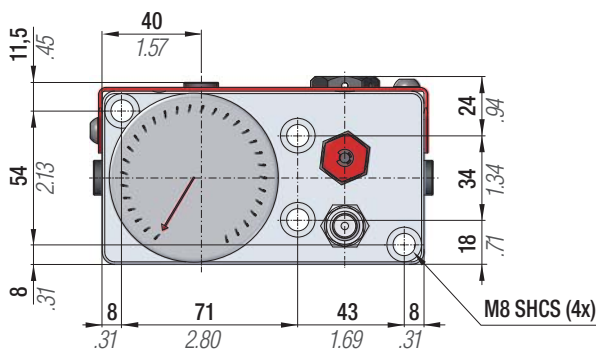

code 39TS460	4.2 - option
code 39DR004	4.1 - option
	standard 4

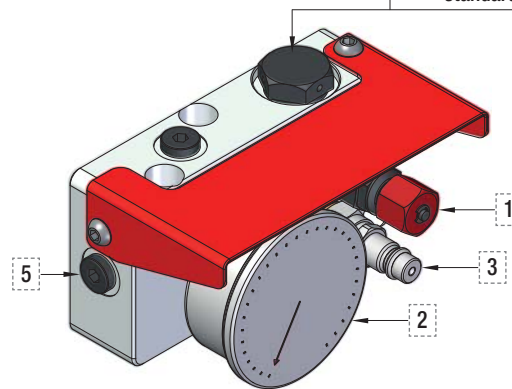
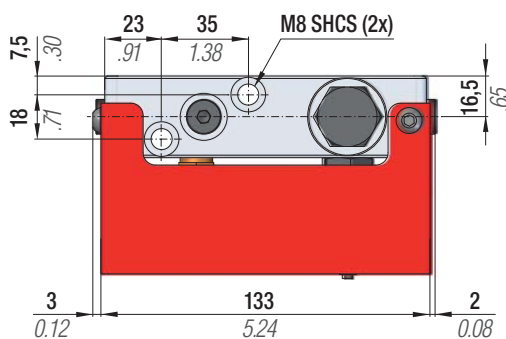

1	Valvola di scarico Discharging valve Auslaßventil Valve de déchargement Válvula de desahogo Válvula de descarga	2	Manometro 0÷ 620 bar Pressure gauge 0÷620 bar Manometer 0÷ 620 bar Manomètre 0÷ 620 bar Manómetro 0÷ 620 bar Manómetro 0÷ 620 bar	3	Innesto rapido di caricamento Cejn Quick coupling for charging Cejn Steckkegel Cejn Accouplement rapide mâle Cejn Acoplamiento rápido para carga Cejn União rápida para carregamento Cejn	4	Tappo di chiusura M20 Closing plug M20 Verschlussstopfen M20 Bouchon de fermeture M20 Tapon de cierre M20 Plugue de fechamento M20	code: 39TS460
4.1	Tappo di rottura sovrappressione Over pressure rupture plug Überdruck Bruch Stecker Bouchon de rupture de surpression Enchufe de ruptura de sobrepresión Plugue ruptura sobrepresão	4.2	Tappo di sicurezza sovrappressione CE Overpressure safety plug CE Überdruck Sicherheitsstecker CE Bouchon de sécurité surpression CE Enchufe de seguridad sobrepresion CE Bujão de segurança sobrepresão CE	5	Fori di collegamento 1/8"G (4x) 1/8"G connecting ports (4x) Anschlussöffnung 1/8"G (4x) Trous de raccordement 1/8"G (4x) Agujeros de conexión 1/8"G (4x) Furo de conexão 1/8"G (4x)			

CONTROL PANEL MCPC



Replace code 39MCPB



IT

Il mini pannello di controllo Special Springs, grazie a un design miniaturizzato e unico, offre una grande flessibilità d'uso che aumenta con le unità aggiuntive AUMCP. Consiste in un blocchetto di alluminio provvisto di manometro, valvola di caricamento e scaricamento, 4 uscite, valvola d'intercettazione e tappo di rottura sovrappressione.

EN

The Special Springs mini control panel, thanks to its unique miniaturized design, offers wide flexibility of use, increased when combined with additional AUMCP units. It consists of a aluminium block with pressure gauge, charging and discharging valve, 4 outlets, on-off valve and overpressure rupture plug.

DE

Die Mini-Steuerung Special Springs bietet dank ihres miniaturisierten und einzigartigen Designs größte Benutzungsflexibilität, die mit den zusätzlichen AUMCP-Einheiten noch erhöht wird. Bestehend aus einem aluminiumblock mit Manometer, Lade- und Entladeventil, 4 Ausgängen, Sperrventil und Überdruck Bruch Stecker.

FR

Grâce à une conception miniaturisée et unique, le mini-panneau de contrôle Special Springs offre une grande souplesse d'utilisation qui augmente avec les unités supplémentaires AUMCP. Il est formé par une plaque en aluminium équipée de manomètre, vanne de chargement et déchargement, 4 sorties, vanne d'arrêt et Bouchon de rupture surpression.

ES

El mini-panel de control Special Springs, gracias a su exclusivo diseño miniaturizado, ofrece una gran flexibilidad, que aumenta con las unidades adicionales AUMCP. Consiste en una placa de aluminio con manómetro, válvula de carga y descarga, 4 salidas, válvula de interceptación y enchufe de ruptura de sobrepresión.

PT

O mini-pannel de controlo Special Springs, graças a um design miniaturizado e exclusivo, oferece uma grande flexibilidade de utilização que aumenta com as unidades adicionais AUMCP. É composto por um bloco em alumínio com manómetro, válvula de carga e de descarga, 4 saídas, válvula de interceptação e plugue de ruptura sobrepresão.

code	Pressure Gauge	Rupture Plug
39MCPC	bar/psi	✓

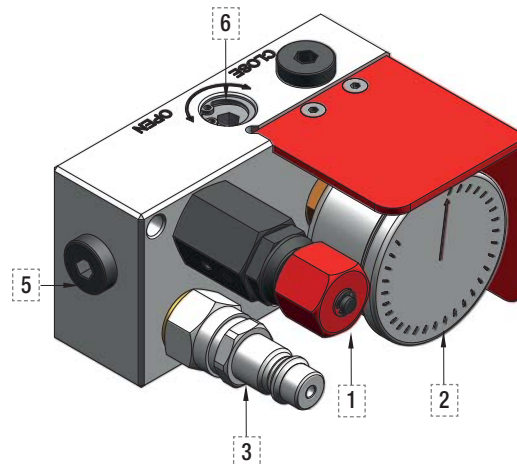
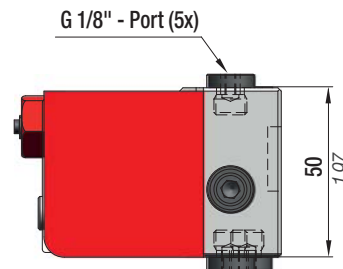
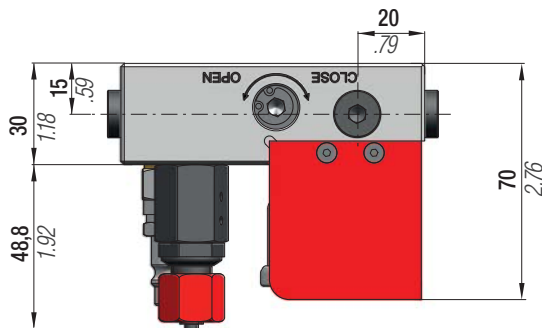
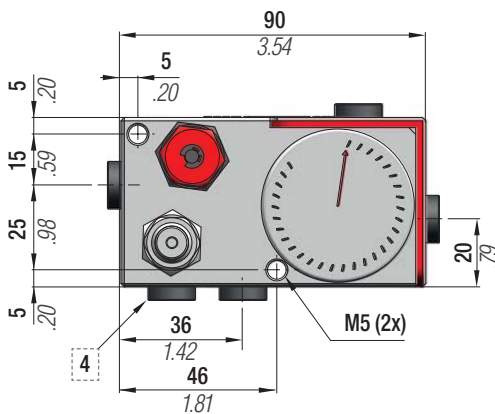

1	Valvola di scarico Discharging valve Auslaßventil Valve de déchargement Válvula de desahogo Válvula de descarga	2	Manometro 0÷ 620 bar Pressure gauge 0÷620 bar Manometer 0÷ 620 bar Manomètre 0÷ 620 bar Manómetro 0÷ 620 bar Manómetro 0÷ 620 bar
3	Innesto rapido di caricamento Quick coupling for charging Steckkegel Cejn Accouplement rapide mâle Cejn Acoplamiento rápido para carga União rápida para carregamento Cejn	4	Tappo di rottura sovrappressione Over pressure rupture plug Überdruck Bruch Stecker Bouchon de rupture de surpression Enchufe de la ruptura de sobrepresión Plugue ruptura sobrepresão
		5	Fori di collegamento 1/8"G (5x) 1/8"G connecting ports (5x) Anschlussöffnung 1/8"G (5x) Trous de raccordement 1/8"G (5x) Agujeros de conexión 1/8"G (5x) Furo de conexão 1/8G (5x)
		6	Valvola di intercettazione Shut off valve Sperrventil Valve d'arrêt Válvula de interceptación Válvula de fecho



p. 211

IT

Unità addizionali per minipannello MCPC. Ideali per gestire impianti o cilindri singoli con pressioni diverse nello stesso stampo. Ogni unità include un manometro, una valvola di intercettazione e 1 uscita. Combinazione massima prevista 1 MCPC + 4 AUMCP.

EN

Additional units for the mini control panel MCPC. Ideal for operating hoses systems or single cylinders with different pressures in the same mould. Each unit includes pressure gauge, on-off valve and 1 outlet. Designed for a maximum combination of 1 MCPC + 4 AUMCP.

DE

Zusätzliche Einheiten für die Ministeuerung MCPC. Ideal zur Verwaltung von Anlagen oder einzelnen Zylindern, die beim selben Formprozess verschiedene Druckwerte aufweisen. Jede Einheit ist mit einem Manometer, einem Sperrventil und einem Ausgang ausgestattet. Maximal mögliche Kombination: 1 MCPC + 4 AUMCP.

FR

Unités supplémentaires pour le mini-panneau MCPC. L'idéal pour gérer des installations ou des cylindres seuls sous des pressions différentes dans le même moule. Chaque unité inclut un manomètre, une vanne d'arrêt et 1 sortie. Combinaison maximum prévue: 1 MCPC + 4 AUMCP.

ES

Unidades adicionales para mini-panel MCPC. Ideales para la gestión de sistemas o de cilindros aislados con presiones distintas en un mismo molde. Cada unidad incluye un manómetro, una válvula de interceptación y 1 salida. Combinación máxima prevista 1 MCPC + 4 AUMCP.

PT

Unidade adicional para mini-painel MCPC. Ideais para gerir instalações ou cilindros individuais com pressões diferentes na mesma ferramenta. Cada unidade inclui um manómetro, uma válvula de interceptação e 1 saída. Combinação máxima prevista 1 MCPC + 4 AUMCP.

code	Pressure Gauge	Rupture Plug
39AUMCP	bar/psi	✓

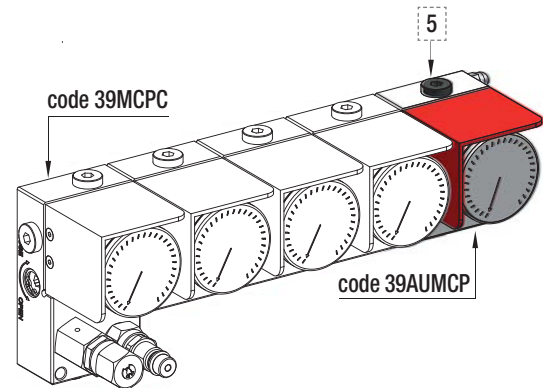
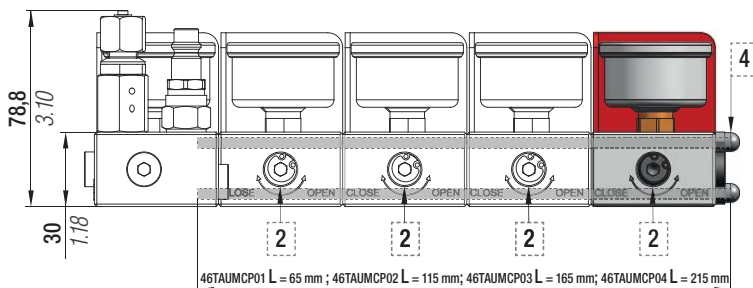
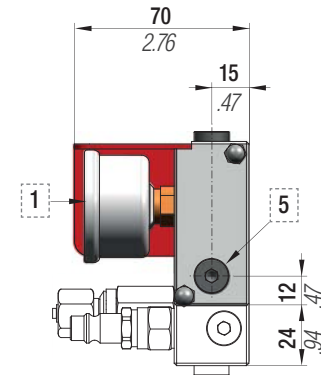
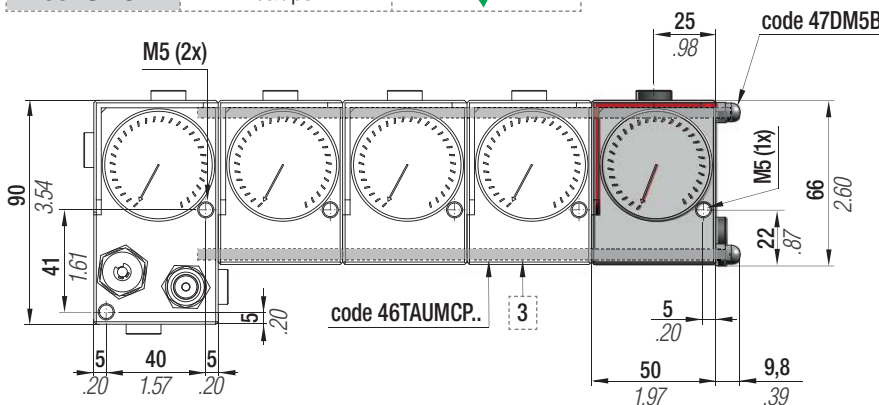

1	Manometro 0÷ 620 bar Pressure gauge 0÷ 620 bar Manometer 0÷ 620 bar Manomètre 0÷ 620 bar Manómetro 0÷ 620 bar	Valvola di intercettazione Shut off valve Sperrventil Valve d'arrêt Válvula de interceptación Válvula de fecho	Tirante (2x) Tie rod (2x) Zugstange (2x) Tirant (2x) Tirante (2x) Barra de ligação (2x)	Dado cieco (2x) Cap nut (2x) Hutmutter (2x) Écrou borgne (2x) Tuerca de sombrerete (2x) Porca cega (2x)	Fori di collegamento 1/8"G (2x) 1/8"G connecting ports (2x) Anschlussöffnung 1/8"G (2x) Trous de raccordement 1/8"G (2x) Agujeros de conexión 1/8"G (2x) Furo de conexão 1/8G (2x)
---	---	---	--	--	---

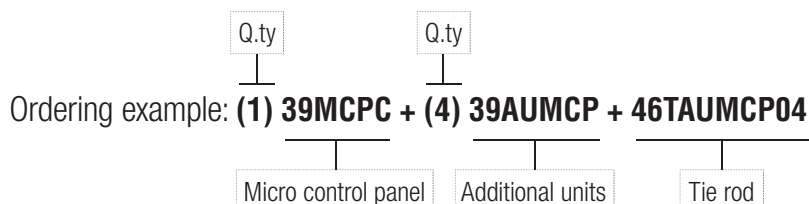

Ordering options code

- (1) 39MCPC + (1) 39AUMCP + 46TAUMCP01
- (1) 39MCPC + (2) 39AUMCP + 46TAUMCP02
- (1) 39MCPC + (3) 39AUMCP + 46TAUMCP03
- (1) 39MCPC + (4) 39AUMCP + 46TAUMCP04

CONTROL PANEL CP02A / CP08A / CP11A ■ (FORD and GM North America die Standard)



IT

Pannello di controllo secondo standard Ford e GM Nord America. Base in alluminio provvista di manometro, valvola di caricamento e scaricamento, adattatore 9/16-18 UNF ORFS, tappo di rottura sovrappressione e protezione in acciaio. 3 uscite G1/8" per gestione sistemi collegati.

EN

Control panel according to Ford and GM North America standards. Made up of aluminium base. Gauge, charging and discharging valve, 9/16-18 UNF ORFS adapter, over pressure rupture plug and steel protection.

DE

Kontrollarmatur gem. Ford und GM North America Normen. Aufgebaut auf Aluminiumsockel. Manometer, Auffüll- und Ablassventil, 9/16-18 UNF ORFS Adapter, Überdruck Bruch Stecker und Stahlabdeckung. 3 G1/8" Anschlüsse.

FR

Panneau de contrôle selon les standards Ford et GM, Amérique du Nord, base en aluminium. Manomètre, valve de chargement et déchargement, adaptateur 9/16-18 UNF ORFS, Bouchon de rupture de surpression et protection acier, 3 ports G1/8".

ES

Panel de control según standard Ford y GM Norte America. Base de aluminio con manómetro, válvula de carga y descarga, adaptador 9/16-18 UNF ORFS, Enchufe de ruptura de sobrepresión y protección en acero. 3 salidas G1/8" para sistemas de cilindros conectados.

PT

Painel de controlo de acordo com os Standards Ford e GM América do Norte. Fabricado a partir de uma base de alumínio, manómetro, válvula de carga e descarga, adaptador ORFS 9/16-18 UNF, Plugue ruptura sobrepresão e protecção em aço. 3 saídas G1/8" para sistemas de gestão relacionados.

code	Pressure Gauge	Rupture Plug
39CP02A	bar/psi	✓
39CP08A	bar/MPa	✓
39CP11A ■	bar/psi	✗

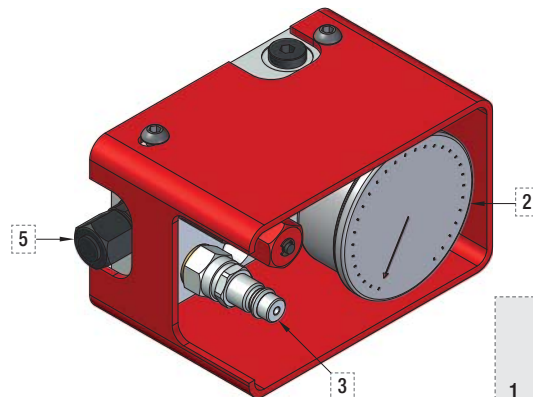
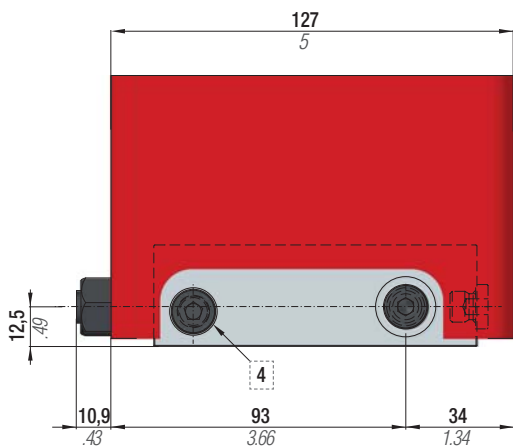
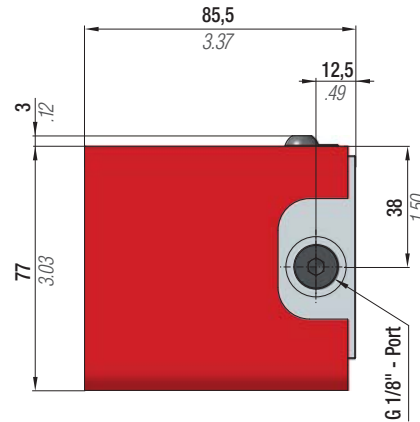
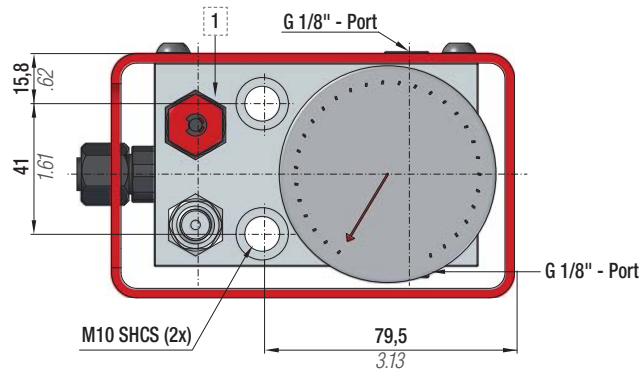

1
Valvola di scarico
Discharging valve
Auslaßventil
Valve de déchargement
Válvula de desahogo
Válvula de descarga

2 Manometro 0÷ 620 bar Pressure gauge 0÷ 620 bar Manometer 0÷ 620 bar Manomètre 0÷ 620 bar Manómetro 0÷ 620 bar Manómetro 0÷ 620 bar	3 Innesto rapido di caricamento Cejn Quick coupling for charging Cejn Steckkegel Cejn Accouplement rapide mâle Cejn Acoplamiento rápido para carga Cejn União rápida para carregamento Cejn	4 Tappo di rottura sovrappressione Over pressure rupture plug Überdruck Bruch Stecker Bouchon de rupture de surpression Enchufe de la ruptura de sobrepresión Plugue ruptura sobrepresão	5 Adattatore tenuta frontale 9/16-18 UNF O-Ring Face Seal Adapter 9/16-18 UNF O-ring-Dichtung Adapter 9/16-18 UNF Joint torique adaptateur 9/16-18 UNF O-ring face seal adapter 9/16-18 UNF Adaptador de vedação frontal 9/16-18 UNF
--	---	--	--

CONTROL PANEL CP06A / CP09A



IT
Pannello di controllo con base in alluminio provvisto di sensore di pressione con display digitale, valvola di caricamento e scaricamento, tappo di rottura sovrappressione, protezione in acciaio, 2 uscite da 1/8" gas per gestione sistemi collegati. Collegando direttamente il sensore di pressione al controllo pressa è possibile impostare un range di lavoro desiderato al di fuori del quale il dispositivo invierà un segnale di allarme.

EN
Control panel with aluminium base, equipped with pressure sensor with digital display, charging and discharging valve, over pressure rupture plug, steel protection and two 1/8" gas outlets for hose system managing. By connecting directly the pressure sensor with the Press control unit, it is possible to set a desired working range, outside this value, the control unit will send an alarm signal.

DE
Kontrollarmatur mit Aluminiumsockel, ausgestattet mit Drucksensor aus digitaler Display, auffüll- und Ablassventil, Überdruck Bruch Stecker, Stahlabdeckung und zwei 1/8" Anschlüsse zur Steuerung der Verbundsysteme. Bei der direkten Verbindung des Drucksensors mit Pressesteuerung es ist möglich eine erwünschte Arbeitsreichweite anzulegen, außerhalb dieser Wert wird der Steuerung ein Alarm Signal zu senden.

FR
Panneau de contrôle avec embase en aluminium, équipé de senseur de pression à écran numérique, chargement et déchargement valve, Bouchon de rupture de surpression, protection en acier et deux sorties 1/8 gaz pour la gestion des systèmes connectés. En reliant directement le senseur de pression au système de gestion de la presse on peut établir un éventail désiré des valeurs de travail, au dehors de ces valeurs, le dispositif émettra un signal d'alarme.

ES
Panel de control con base de aluminio, provisto de sensor de presión con display digital, válvula de carga y descarga, Enchufe de ruptura de sobre presión, protección en acero, 2 salidas de 1/8" gas para gestión de sistemas conectados. Conectando directamente el sensor de presión al control de la prensa es posible determinar unos rangos de trabajo, fuera de los cuales el dispositivo envía una señal de alarma.

PT
Painel de controlo com base de alumínio, equipado com sensor de pressão digital, válvula de carga e descarga, Plugue ruptura sobrepressão, sistema de protecção de aço e duas tomadas de 1/8" gas para ligação a mangueiras. ao ligar directamente o sensor de pressão com a unidade de controlo, é possível definir o funcionamento desejado, fora destes valores, a unidade de controlo envia um sinal de alarme.

code	Pressure Gauge	Rupture Plug
39CP06A with 59CD01A	bar/psi	✓
39CP09A with 59CR01A	bar/psi	✓

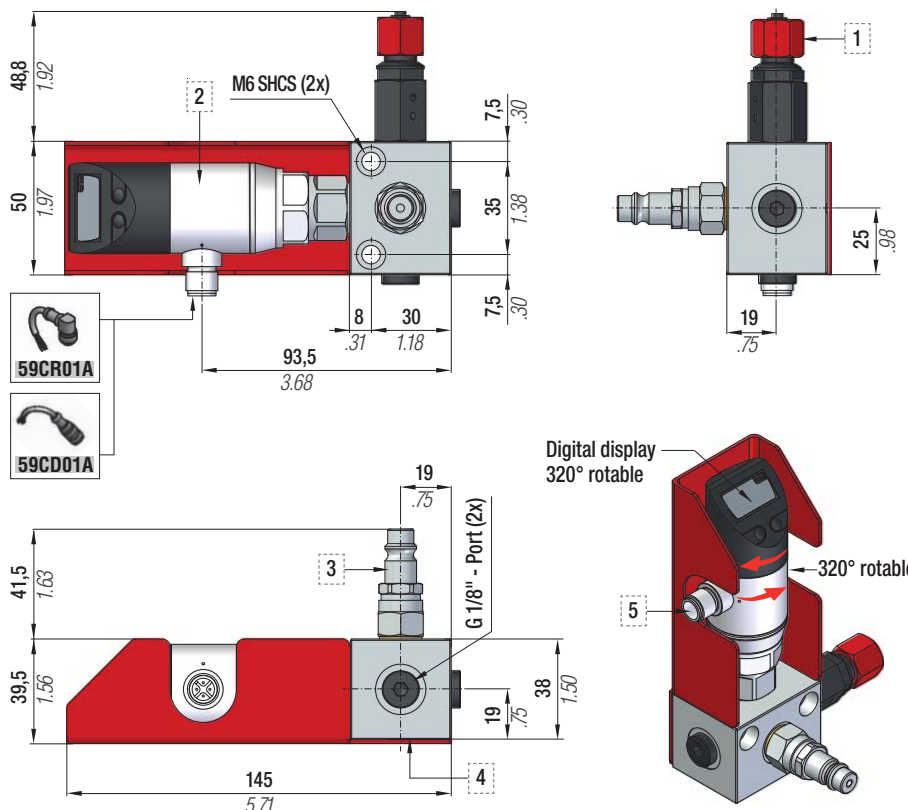

Technical data	
Electrical connector type	M12x1 (4-pin)
Pressure connection	G 1/4" DIN 3852
Nominal pressure	0 - 600 bar
Burst pressure	800 bar
Operating voltage U _o	18...36 V DC
Output current max.	500 mA
No-load supply current I _o max	≤ 50 mA
Switching frequency f	200 Hz
Temperature range	- 25°C... + 85°C
Degree of protection as per IEC 60529	IP67 when connected
Output: digital data (switching points only) 2 x PNP, NO/NC selection	

⚠ Always depressurize and disconnect pressure sensors from the power supply before establishing an electrical connection.

Electrical connections	Sensors with switching output	Sensors with analog output	Wire connections color
Supply +	1	1	Brown
Supply -	3	3	Blue
Signal +	-	2	White
Switching output 1	4	4	Black
Switching output 2	2	-	-
Shield	Connector housing	Connector housing	-

Fig. 1: Sensor diagram with 2 switching outputs

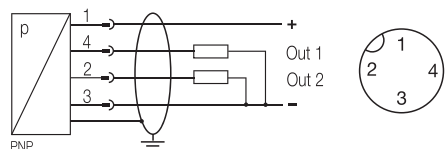
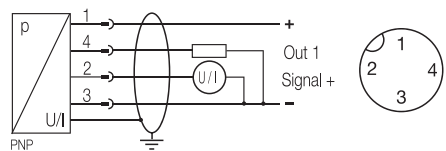

Fig. 2: Sensor diagram with analog output



1 Valvola di scarico Discharging valve Auslassventil Valve de déchargement Válvula de desahogo Válvula de descarga	2 Manometro 0÷ 600 bar Pressure gauge 0÷ 600bar Manometer 0÷ 600 bar Manomètre 0÷ 600 bar Manómetro 0÷ 600 bar Manómetro 0÷ 600 bar	3 Innesto rapido di caricamento Cejn Quick coupling for charging Cejn Steckkegel Cejn Accouplement rapide mâle Cejn Acoplamiento rápido para carga Cejn União rápida para carregamento Cejn	4 Tappo di rottura sovrappressione Over pressure rupture plug Überdruck Bruch Stecker Bouchon de rupture de surpression Enchufe de la ruptura de sobre presión Plugue ruptura sobrepressão	5 Connettore elettrico Electrical connector Elektrische Connecteur électrique Eléctrica Conector Conector elétrico
--	---	---	--	--

IT

Pannello di controllo con base in alluminio provvisto di manometro, valvola di carica-mento e scaricamento, tappo di rottura sovrappressione, protezione in acciaio, 3 uscite da 1/4" gas e un uscita da 1/8" gas per gestione sistemi collegati.

EN

Control panel with aluminium base, equipped with gauge, charging and discharging valve, over pressure rupture plug, steel protection and three 1/4" and one 1/8" gas outlets for hose system managing.

DE

Kontrollarmatur mit Aluminiumsockel, Manometer, auffüll- und Ablassventil, Überdruck Bruch Stecker, Stahlabdeckung, drei 1/4" und eine 1/8" Gas Anschlüsse zur Steuerung der Verbundsysteme.

FR

Panneau de contrôle avec base en aluminium, pourvu de manomètre, valve de chargement-déchargement, bouchon de rupture de surpression, protection en acier et trois sorties 1/4 gaz et une sortie 1/8 gaz pour la gestion des systèmes connectés.

ES

Panel de control con base de aluminio provisto de manómetro, válvula de carga y descarga, enchufe de la ruptura de sobrepresión, protección en acero, 3 salidas de 1/4" gas y 1 salida de 1/8" gas para gestión de sistemas conectados.

PT

Painel de controlo com base de alumínio, equipado com manómetro, válvula de carga e descarga, plugue ruptura sobrepresão, sistema de protecção de aço, três tomadas de 1/4" e uma 1/8" gas para ligação a mangueras.

code	Pressure Gauge	Pressure Switch	Rupture Plug
39CP07A	bar/psi	✗	✓
39CP10A	bar/psi	✓	✓
39CP12A	bar/psi	✗	✗

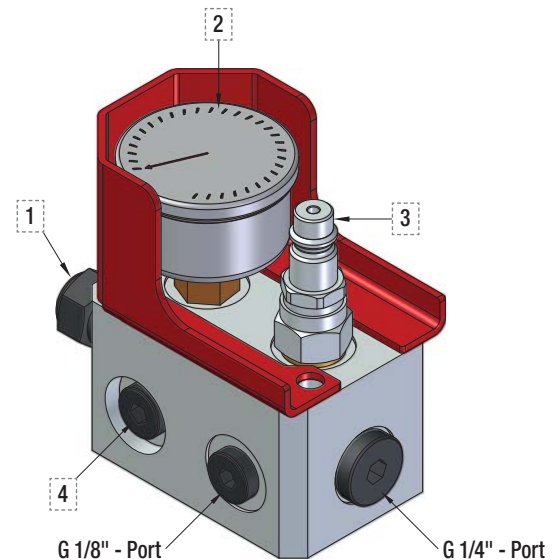
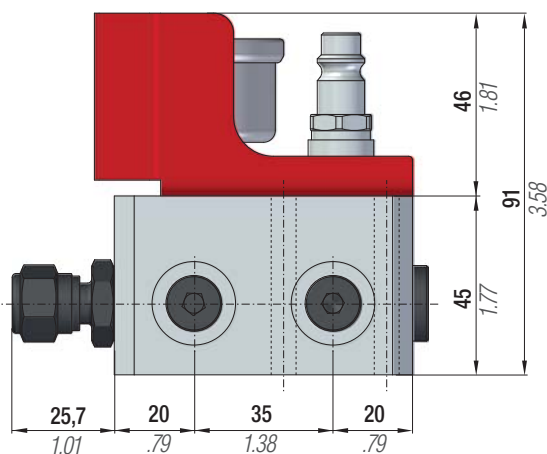
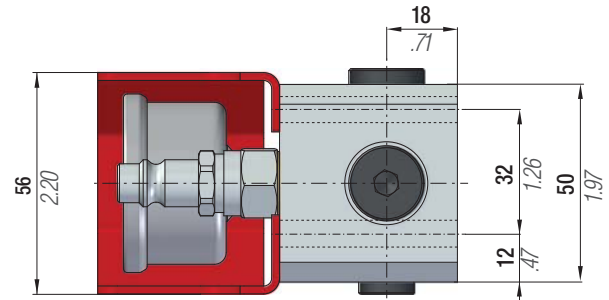
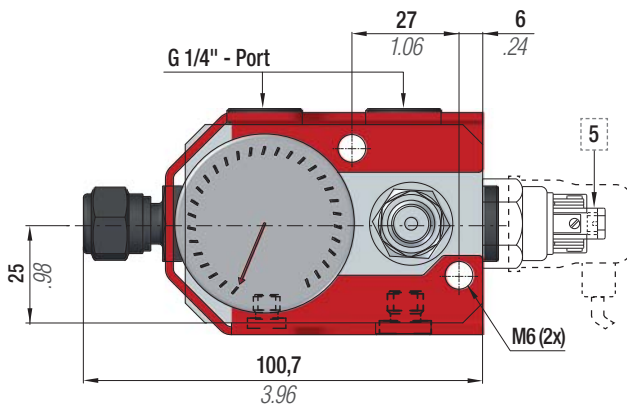

1	Valvola di scarico Discharging valve Auslaßventil Valve de déchargement Válvula de desahogo Válvula de descarga	2	Manometro 0÷ 600 bar Pressure gauge 0÷ 600 bar Manometer 0÷ 600 bar Manomètre 0÷ 600 bar Manómetro 0÷ 600 bar Manómetro 0÷ 600 bar	3	Innesto rapido di carica-mento Cejn Quick coupling for charging Cejn Steckkegel Cejn Accouplement rapide mâle Cejn Acoplamiento rápido para carga Cejn União rápida para carregamento Cejn	4	Tappo di rottura sovrappressione Over pressure rupture plug Überdruck Bruch Stecker Bouchon de rupture de surpression Enchufe de la ruptura de sobrepresión Plugue ruptura sobrepresão	5	Pressostato 50÷300 bar Pressure switch 50÷300 bar Druckwächter 50÷300 bar Pressostat 50÷300 bar Presostato 50÷300 bar Pressostato 50÷300 bar
---	--	---	---	---	---	---	---	---	---



CONTROL PANEL CP15A ■



IT
Pannello di controllo con base in alluminio, provvisto di manometro, valvola di carica e protezione in acciaio. 2 uscite da 1/8" gas per gestione sistemi collegati.

EN
Control panel with aluminum base. Equipped with pressure gauge, charging valve and steel protection. Two 1/8" gas outlets for managing hose system.

DE
Kontrollarmatur mit Aluminiumsockel. Ausgestattet mit Manometer, Auffüllventil und Stahlabdeckung. Zwei 1/8" Gas Anschlüsse zur Steuerung der Verbundsysteme.

FR
Panneau de contrôle avec base en aluminium. Equipé de manomètre, valve de chargement et protection en acier. Deux sorties 1/8" gaz pour la gestion des systèmes connectés.

ES
Panel de control con base de aluminio. Equipado con manómetro, válvula de carga y protección en acero. 2 salidas de 1/8" gas para gestión de sistemas conectados.

PT
Painel de controlo com base de alumínio. Equipado com manómetro, válvula de carga e sistema de protecção de aço. Duas saídas de gás 1/8" para ligação a manguelras.

code	Pressure Gauge	Rupture Plug
39CP15A	bar/psi	X

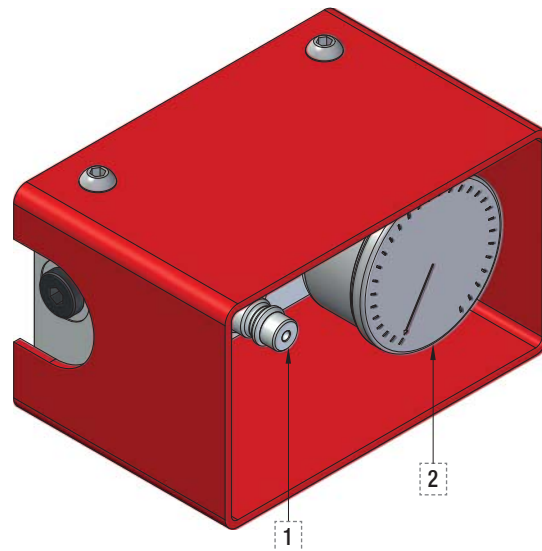
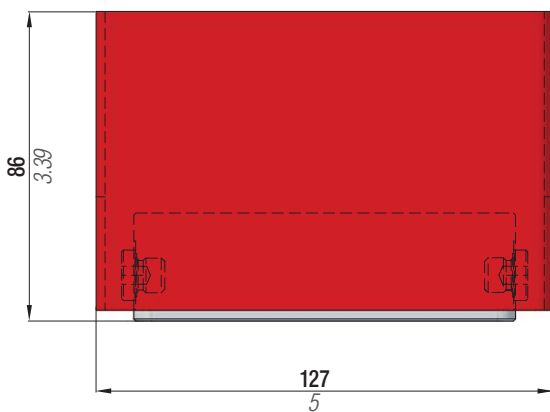
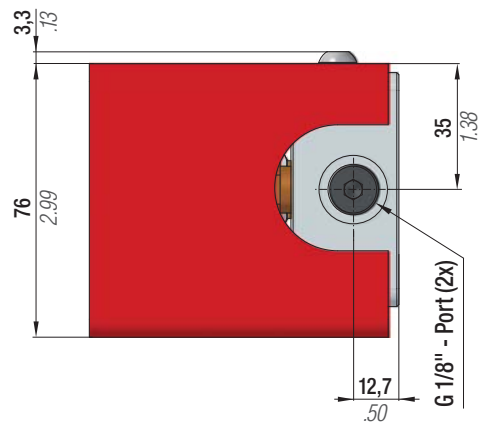
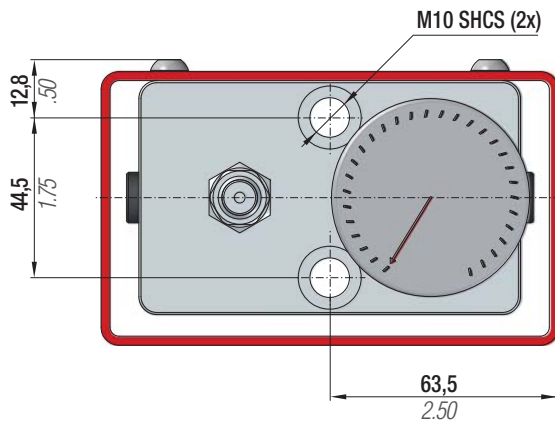

1	Innesto rapido di caricamento Cejn Quick coupling for charging Cejn Steckkegel Cejn Acoplamiento rápido para carga Cejn União rápida para carregamento Cejn	2	Manometro 0÷ 620 bar Pressure gauge 0÷ 620 bar Manometer 0÷ 620 bar Manomètre 0÷ 620 bar Manómetro 0÷ 620 bar Manómetro 0÷ 620 bar
---	---	---	---

code 39VS03A



⚠ Use only for 39CP15A

IT	Dispositivo di scaricamento
EN	Discharging device
DE	Ablassvorrichtung
FR	Dispositif de déchargement
ES	Dispositivo de descarga
PT	Dispositivo de descarga

IT

Pannello di controllo con base in alluminio, provvisto di manometro, valvola di caricamento e scaricamento, tappo di rottura sovrappressione, protezione in acciaio, 3 uscite da 1/8" gas per gestione sistemi collegati.

EN

Control panel with aluminum base. Equipped with pressure gauge, charging and discharging valve, over pressure rupture plug, steel protection, three 1/8" gas outlets for managing hose system.

DE

Kontrollarmatur mit Aluminiumsockel. Ausgestattet mit Manometer, Auffüll- und Ablassventil, Überdruck Bruch Stecker, Stahlabdeckung, drei 1/8" Gas Anschlüsse zur Steuerung der Verbundsysteme.

FR

Panneau de contrôle avec base en aluminium. Equipé de manomètre, valve de chargement-déchargement, bouchon de rupture de surpression, protection en acier, trois sorties 1/8" gaz pour la gestion des systèmes connectés.

ES

Panel de control con base de aluminio. Equipado con manómetro, válvula de carga y descarga, enchufe de la ruptura de sobrepresión, protección en acero, 3 salidas de 1/8" gas para gestión de sistemas conectados.

PT

Painel de controlo com base de alumínio. Equipado com manómetro, válvula de carga e descarga, plugue ruptura sobrepresão, sistema de protecção de aço, três saídas de gás 1/8" para ligação a mangueiras.

code	Pressure Gauge	Rupture Plug
39CP16A	bar/psi	✓

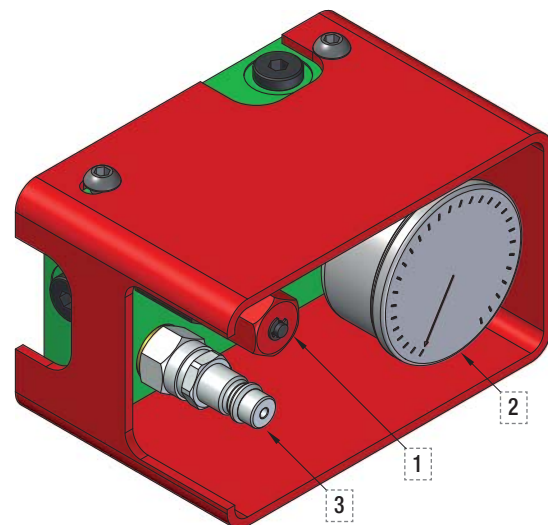
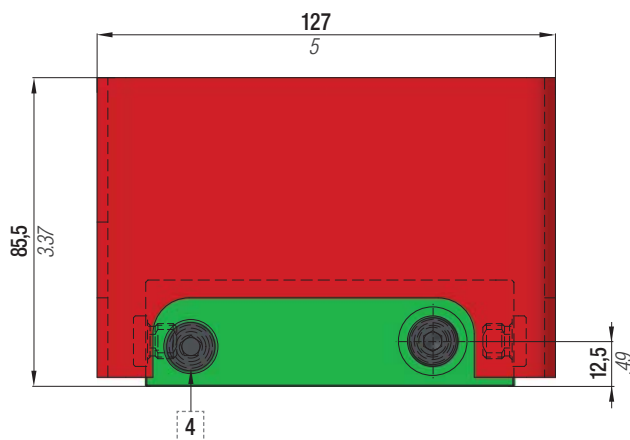
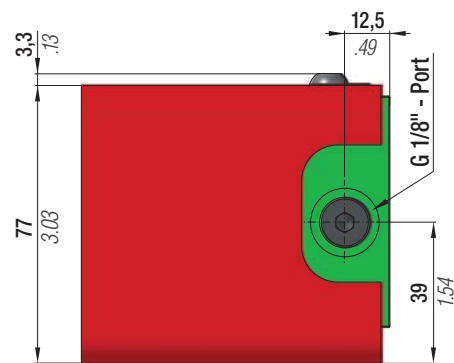
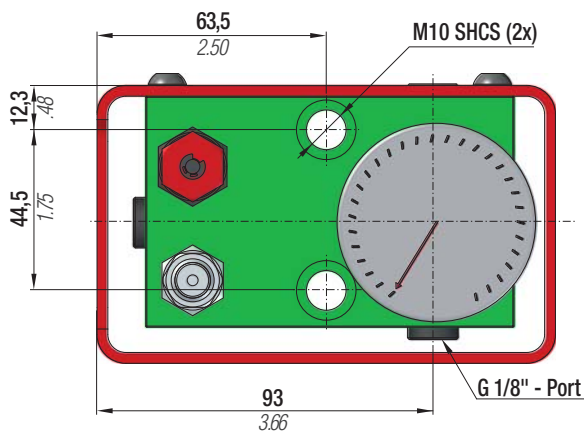

1	Valvola di scarico Discharging valve Auslaßventil Valve de déchargement Válvula de desahogo Válvula de descarga	2	Manometro 0÷ 620 bar Pressure gauge 0÷ 620 bar Manometer 0÷ 620 bar Manomètre 0÷ 620 bar Manómetro 0÷ 620 bar Manómetro 0÷ 620 bar	3	Innesto rapido di caricamento Cejn Quick coupling for charging Cejn Steckkegel Cejn Accouplement rapide mâle Cejn Acoplamiento rápido para carga Cejn União rápida para carregamento Cejn	4	Tappo di rottura sovrappressione Over pressure rupture plug Überdruck Bruch Stecker Bouchon de rupture de surpression Enchufe de la ruptura de sobrepresión Plugue ruptura sobrepresão
---	--	---	---	---	--	---	---



DISTRIBUTION BLOCKS



code 39BD0301A

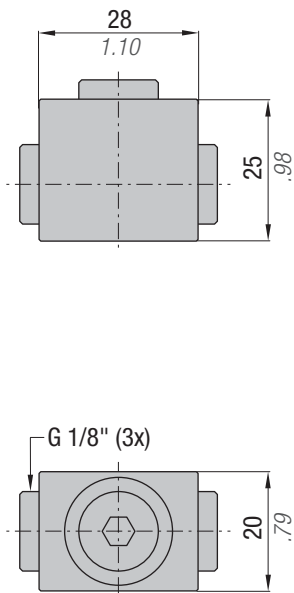

code 39BD0401A

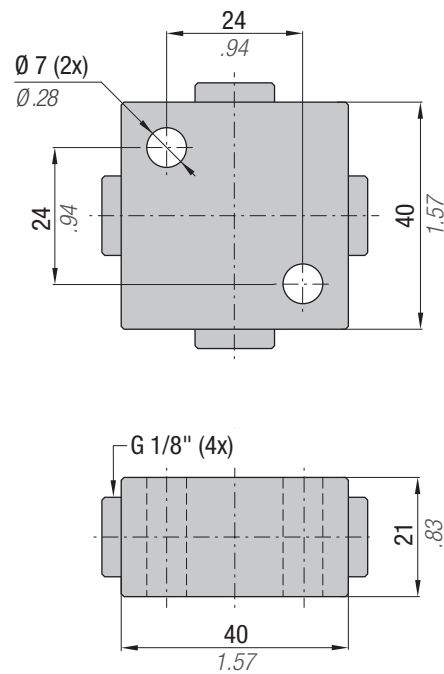

code 39BD0402A

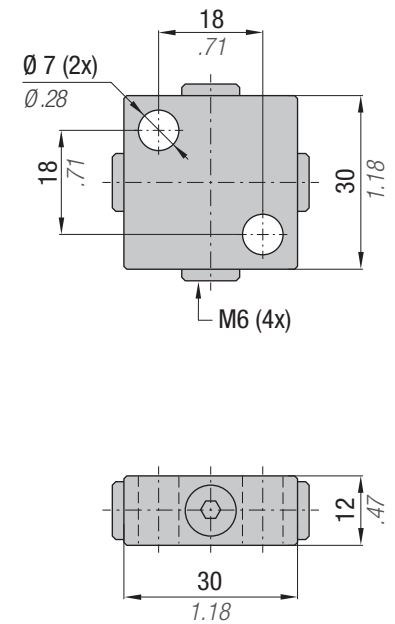

code 39BD06A

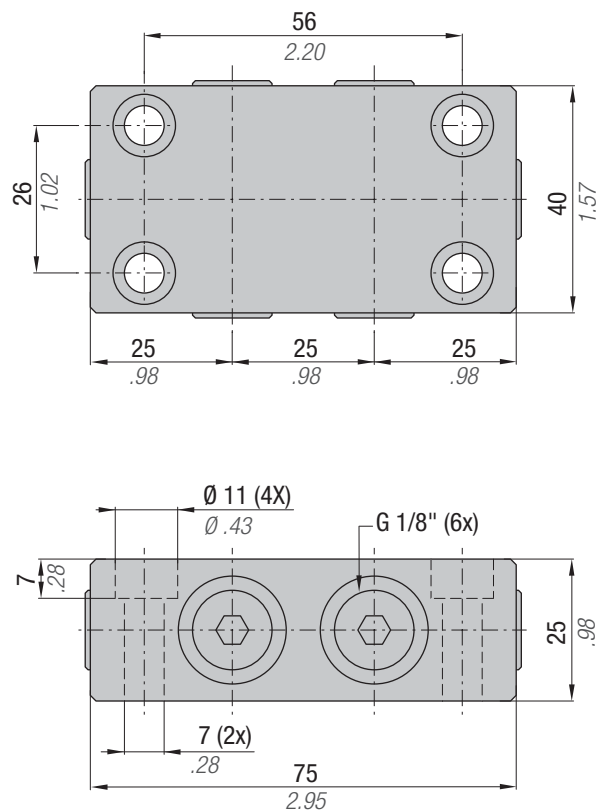

code 39BD0601A

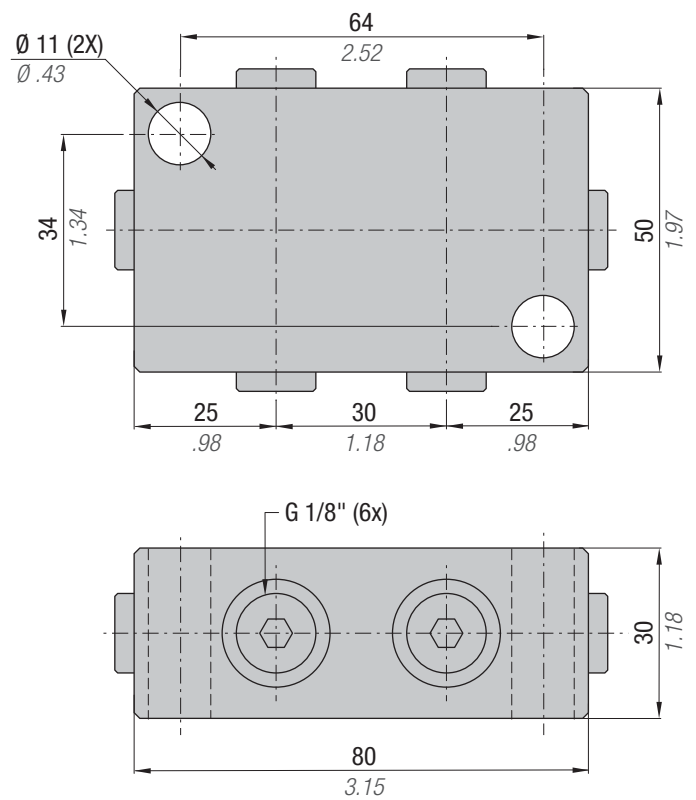

code 39BD06/1

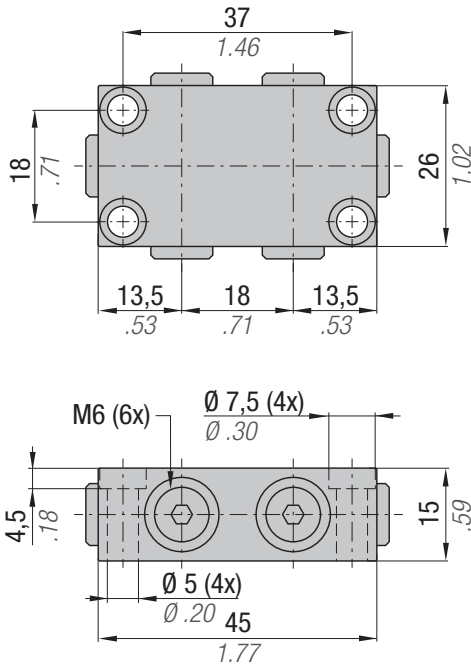

code 39BD06/2

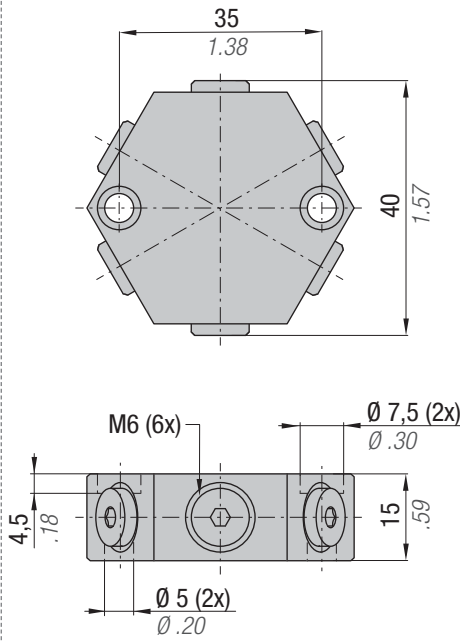

code 39BD0603A

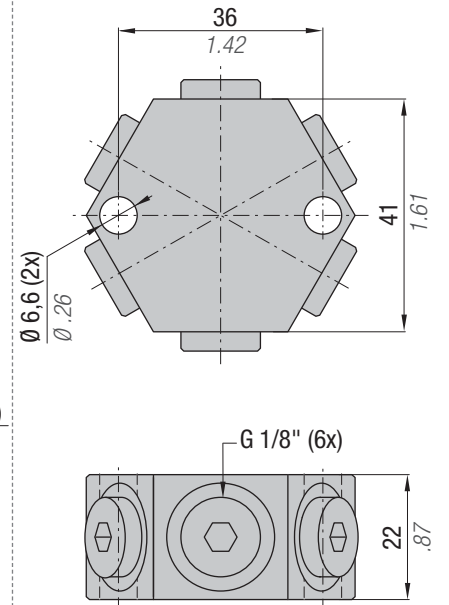

code 39BD0801A

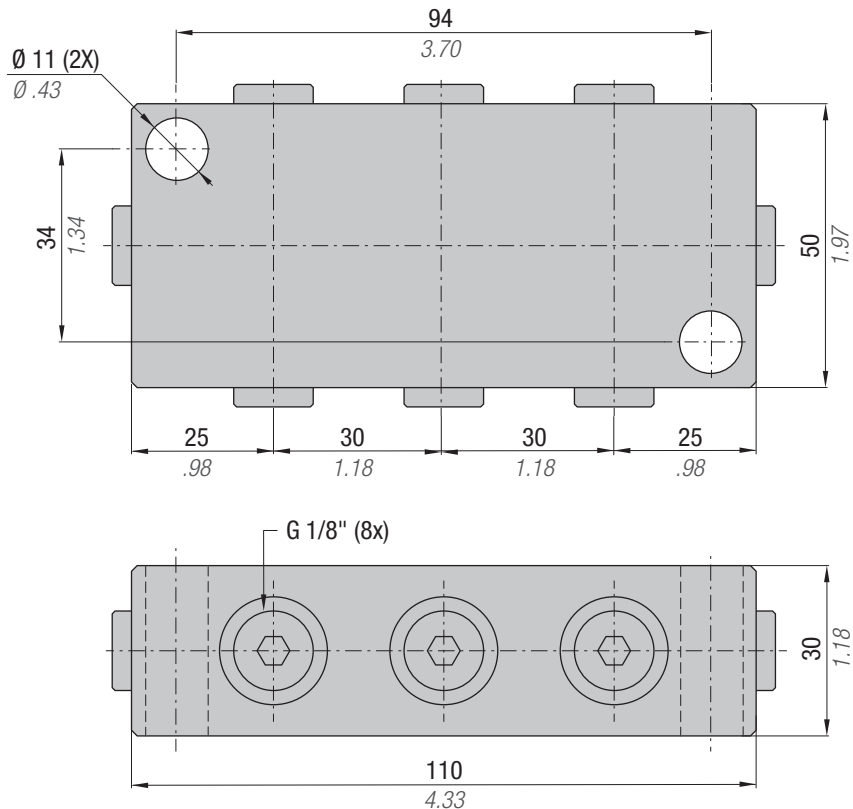

All dimensions in mm/inch

